

» LIFESTYLE RANGE Milestone 11



 Style 1: Metal tile gable roof with Linea and plaster cladding



 Style 2: Metal tile hip roof with Linea, brick and plaster cladding



 Style 3: Metal tile gable roof with brick and Linea cladding

The Lifestyle range features 30 stylish home designs created by Milestone Homes to deliver comfortable, quality homes ideal for modern living. Functional and flexible, the cleverly designed Lifestyle range has a proven track record of happy homeowners from professional couples to large families.

Milestone 11

Created with modern styling and surprising space, this plan provides everything you need in a four-bedroom home.

Offering large living spaces, an open plan kitchen and separation with lounge and dining whilst everything still feeling central, this home fits all of the principles of a well thought out and perfectly optimised design.

Highlights:

- Effortless flow to the alfresco area makes for easy entertaining with family and friends
- Double garage which includes a workshop nook to keep all of the tools and toys
- Full-sized separate laundry room offers a popular feature of this plan
- Plenty of storage is key to this well-functioning home.

204m²



Bedrooms



Bathrooms





Living / Dining



Garage



 0800 MILESTONE
 milestonehomes.co.nz

» LIFESTYLE RANGE

Milestone 11



Home Width	Home Length	Living Area	Garage Area	Total Floor Area
13.83m	21.65m	164.12m ²	39.06m ²	203.69m ²

Measurements are reflective of Style 1

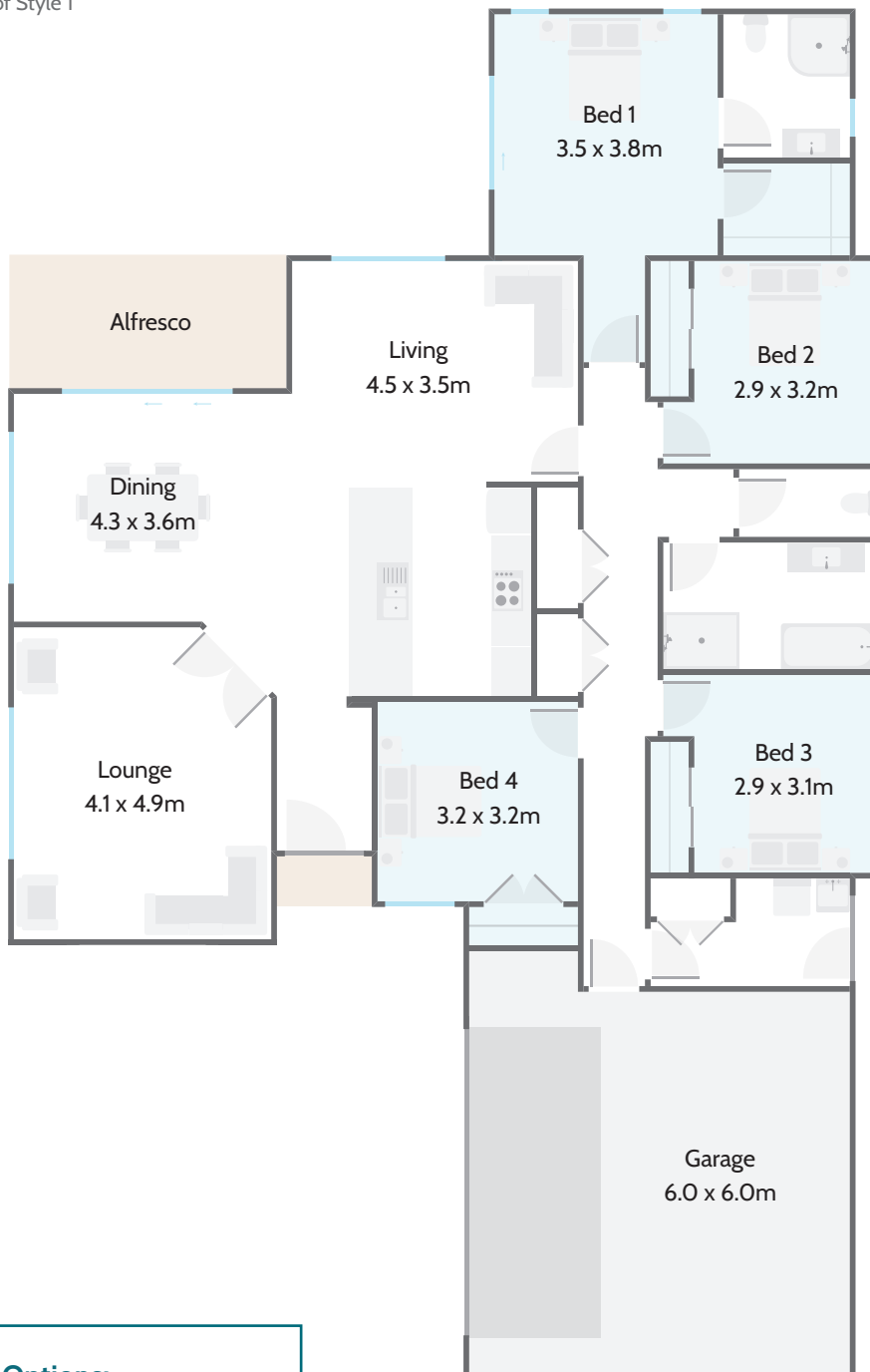

Plan Options:

- Scullery

204m²



Bedrooms



Bathrooms



Living / Dining



Garage



0800 MILESTONE
milestonehomes.co.nz