

» LIFESTYLE RANGE  
Milestone 18



🏠 Style 1: Metal tile hip roof with brick cladding



🏠 Style 2: Longrun mono roof with Linea cladding



🏠 Style 3: Longrun gable roof with plaster and Linea cladding

The Lifestyle range features 30 stylish home designs created by Milestone Homes to deliver comfortable, quality homes ideal for modern living. Functional and flexible, the cleverly designed Lifestyle range has a proven track record of happy homeowners from professional couples to large families.

## Milestone 18

This sharp, adaptable three-bedroom home has been designed with build efficiency and clever use of space in mind.

The open plan enhances living spaces by creating extra room and natural light.

Equipped with a purpose-built scullery, two bathrooms, generous bedrooms and tonnes of storage – no detail has been spared.

With a minimal hallway and double garage, this plan is incredibly efficient offering exceptional value.

### Highlights:

- Master bedroom with ensuite and walk-in-robe
- Can adapt to a two-bedroom or four-bedroom home
- Flexibility with section orientation allowing for a south entry and garage door option.

164m<sup>2</sup>



Bedrooms



Bathrooms



Living / Dining



Garage



📞 0800 MILESTONE  
🌐 [milestonehomes.co.nz](http://milestonehomes.co.nz)

# » LIFESTYLE RANGE

## Milestone 18



Home Width	Home Length	Living Area	Garage Area	Total Floor Area
10.80m	20.20m	121.89m <sup>2</sup>	41.64m <sup>2</sup>	163.53m <sup>2</sup>

Measurements are reflective of Style 1

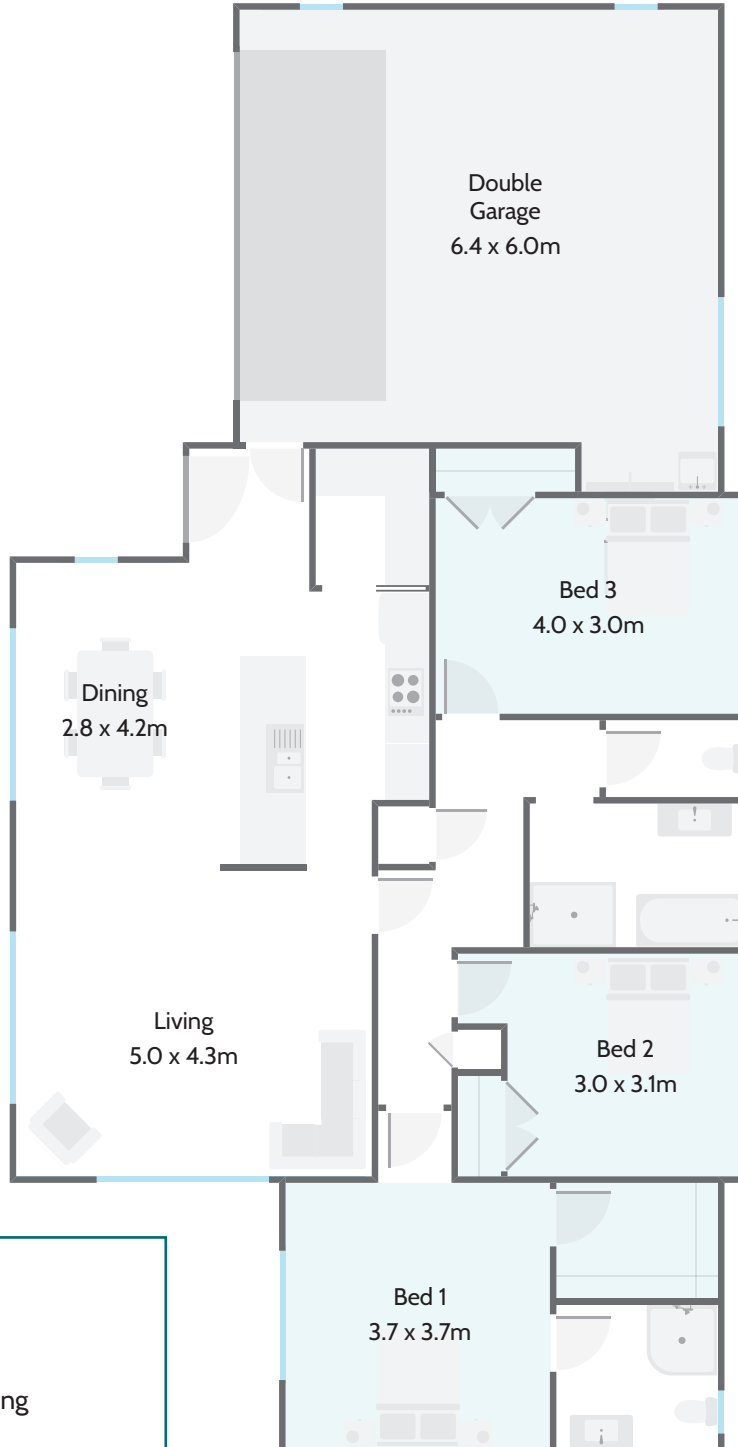

### Plan Options:

- 2 Bedroom
- 4 Bedroom
- Increased Dining
- Alfresco Area
- South Entry

164m<sup>2</sup>



Bedrooms



Bathrooms



Living / Dining



Garage



0800 MILESTONE  
milestonehomes.co.nz