

» LIFESTYLE RANGE Milestone 30



🏠 Style 1: Metal tile hip roof with brick cladding



🏠 Style 2: Metal tile gable roof with plaster cladding



🏠 Style 3: Longrun gable roof with Linea cladding

The Lifestyle range features 30 stylish home designs created by Milestone Homes to deliver comfortable, quality homes ideal for modern living. Functional and flexible, the cleverly designed Lifestyle range has a proven track record of happy homeowners from professional couples to large families.

Milestone 30

This is a luxuriously proportioned home for people looking for generous living areas whilst retaining a more modest two bedrooms.

The generous central kitchen overlooks and flows seamlessly out to the recessed alfresco area, which is a fantastic addition to this home for added street appeal and a fabulous entertaining space.

The hall cupboard and a large laundry nook in the double garage affords this home plentiful storage.

The street presence of this home provides the illusion of a much larger property and with stylish façade options, this home is great choice.

Highlights:

- Effortless flow to the alfresco area makes for easy entertaining with family and friends.

145m²



Bedrooms



Bathrooms



Living / Dining



Garage



📞 0800 MILESTONE
🌐 milestonehomes.co.nz

» LIFESTYLE RANGE

Milestone 30



Home Width	Home Length	Living Area	Garage Area	Total Floor Area
15.35m	11.90m	107.04m ²	38.43m ²	145.47m ²

Measurements are reflective of Style 1

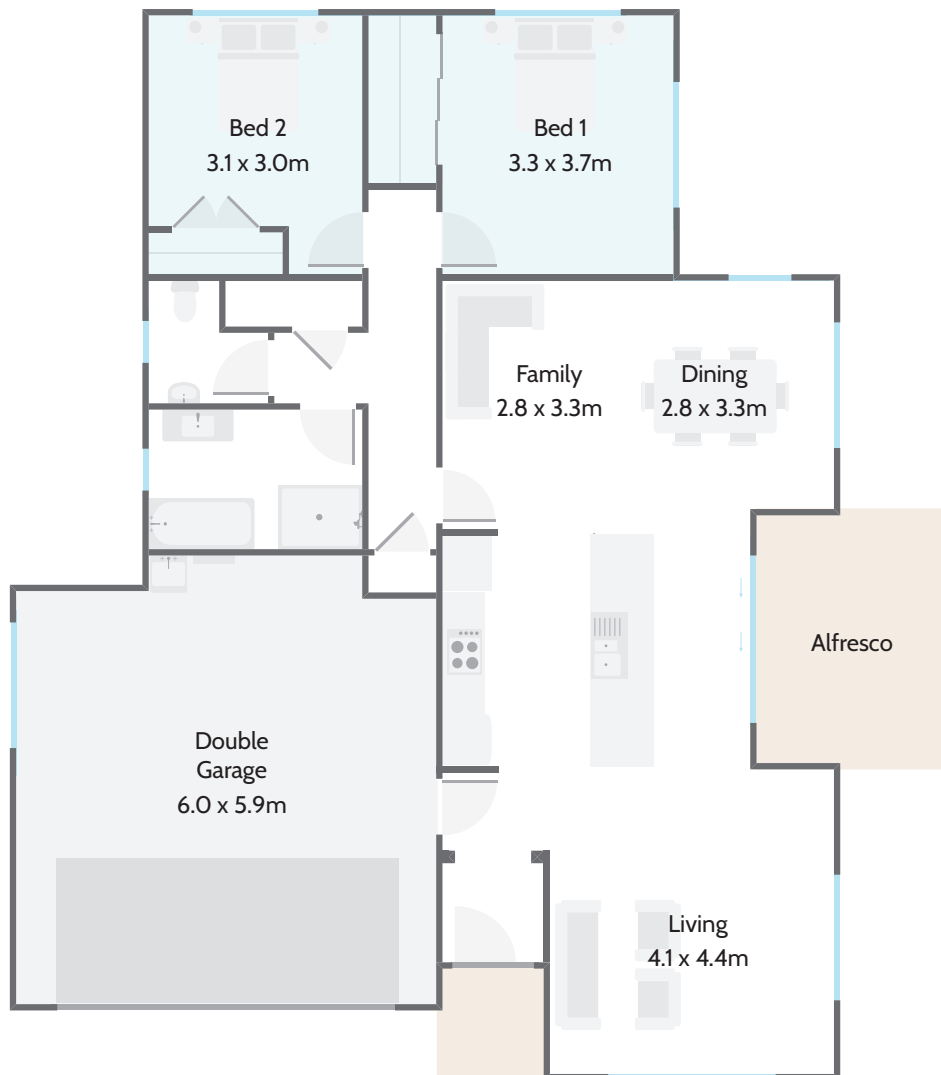

Plan Options:

- 3 Bedroom and Ensuite
- Single Garage

145m²

Bedrooms

Bathrooms

Living / Dining

Garage



0800 MILESTONE
milestonehomes.co.nz