



192m² | 3 bdrm





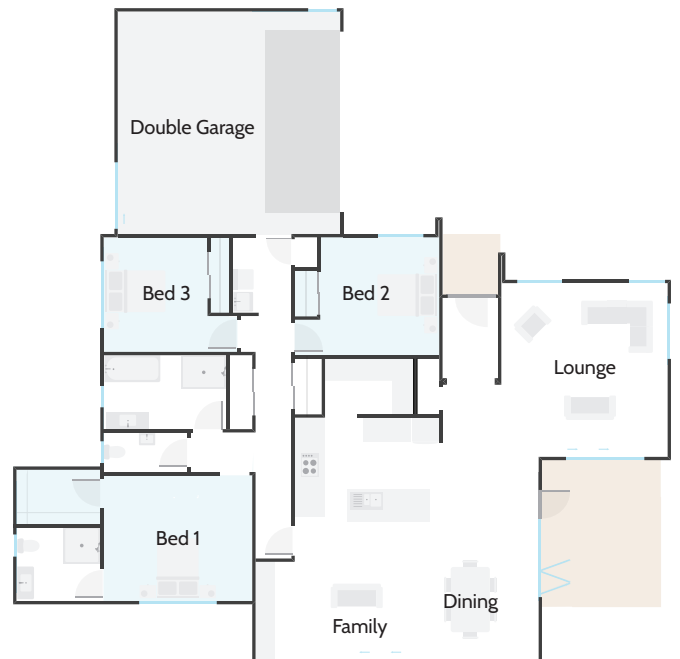

Smart Living





This show home is a stellar example of a family home that perfectly blends form and function. With extensive glazing and indoor-outdoor flow, the home invites the sunshine in and unites spaces seamlessly. Designed to utilise space effectively, the layout features three smartly arranged bedrooms, two bathrooms, a partitionable lounge, separate laundry and hidden study nook that can be closed away behind bi-fold doors. Best yet, the exceptional quality on display here is everything you can expect in your own Milestone home.



Milestone 3

- Bedrooms

- Bathroom

- Ensuite

- Living

- Garage

Milestone Homes Otago

-  6 Silverdale Place, Highland Park, Mosgiel
-  03 489 8111
-  otago@milestonehomes.co.nz
-  milestonehomes.co.nz

Talk to us about Smart House and Land Packages Available Now

Undertakings

- Locally owned – Nationally supported
- 10 Year Master Build Guarantee
- Comprehensive Aftercare Package including remedial defects assurance
- Building Consents, BRANZ and MBIE Levies
- Preferred local suppliers and sub-trades

Structural Works

- Engineer designed raft concrete floor

Site Works

- Concrete exposed aggregate drive, plain brushed concrete
- Evalast decking
- Ready lawn
- Timber fencing to side boundaries and rear

Exterior

- Carbon-neutral, treated timber frames and trusses
- Double glazed aluminium joinery with thermally enhanced frames and Low E glass
- R2.6 insulation to exterior walls and R4.0 to ceilings including garage
- APL Latitude Entry Door with electronic digital entry lock
- Garador Newport insulated garage door with automatic opener & 2 remotes
- Hose taps to front and rear of the house (2)
- NZ Steel corrugate roof
- Colorsteel fascia, spouting and downpipes
- Feature designer bricks from The Brickery
- Rockcote EPS 50 plaster system
- Accoya weatherboard

Interior Linings

- Walls: 10mm Winstone GIB Board
- Ceilings: 13mm Winstone GIB Board
- Wet Areas: Winstone GIB Aqualine
- 55mm Gib Cove cornice
- Pine skirtings with bevel edge

Executive Kitchen

- 40mm Tri stone acrylic benchtop
- Undermounted double bowl stainless steel sink including an in-sink waste disposal unit & air switch
- Feature kitchen mixer
- Walk-in pantry with melamine shelves and 40mm laminate bench with FRIO edge
- Soft-close draws and doors
- Feature bulkhead
- Fisher and Paykel appliances
- Full-width feature tiled splashback to cooktop wall and pantry

Interiors

- Grooved panel doors with grooved jambs
- Schlage Rivera door furniture
- Custom joinery to all bedroom wardrobes
- Feature built-in Laundry
- Nook joinery

Bathrooms

- Clearlite Cashmere vanities with vitreous china tops
- Athena Soul shower
- Wall tiles in ensuite shower
- Clearlite Varo left freestanding bath
- Ideal Standard tapware and slide shower fittings
- Robertson Uno CC BTW Toilet Suites
- Heated towel warmers - Main bathroom and Ensuite
- Tiled ensuite floor with undertile heating
- Clearlite Mimas 400 vanity in WC

Electrical

- Audiovisual communications hub
- LED low-energy recessed downlights
- HPM electrical switch components
- Exterior security lights
- Inline extractor fans – Main bathroom, ensuite and laundry
- Fibre internet ready
- 4 data or phone outlets
- 2 television outlets
- Rinnai Infinity gas hot water
- Solartube with LED light in laundry

Floor Coverings

- Karndean korlock laminate flooring to entry, dining, kitchen, scullery and family area
- Belgotec Empire flooring extra heavy-duty, solution-dyed nylon cut pile carpet on luxury 11mm foam underlay in hall and bedrooms
- Bremworth overtones 100% wool carpet to lounge

Decorating

- Washable Resene three-coat premium paint
- Exterior & Interior Designer - Lee-Anne Flockton

Heating

- Panasonic ducted heat pump
- Rinnai Linear 1000 gas fire

Other

- Landscape design by Leaf
- Fisher & Paykel fridge, washing machine and dryer
- Drapes and blinds
- Belgotex garage carpet

Milestone Homes Otago

📍 6 Silverdale Place, Highland Park, Mosgiel

📞 03 489 8111

✉️ otago@milestonehomes.co.nz

🌐 milestonehomes.co.nz