

## » METRO RANGE Ruahine



The Metro range features 10 contemporary home designs created by Milestone Homes to deliver modern living solutions for smaller urban sections. Compact yet packed with new-home comforts, Metro plans are a go-to for professional couples, young families and empty-nesters looking for relaxed, easy-care living.

### Ruahine

Sporting a modern pitched roof and stylish exterior, the Ruahine home plan combines good looks with efficient use of space. With its cleverly designed compact layout, the Ruahine is a great fit for young families, first home buyers or those looking to downsize and simplify.

Comprising three bedrooms, two bathrooms and open plan living connecting with the outdoors, the Ruahine home plan creates a sleek, contemporary home suitable for narrow or smaller sections.

#### Highlights:

- Three generous double bedrooms
- Master bedroom with ensuite and walk-in wardrobe
- Family bathroom plus separate toilet
- Generous storage
- Garden access from master bedroom and living areas.



138m<sup>2</sup>

Bedrooms

Bathrooms

Living / Dining

Garage



📞 0800 MILESTONE  
🌐 [milestonehomes.co.nz](https://milestonehomes.co.nz)

# » METRO RANGE

## Ruahine



<b>Home Width</b>	<b>Home Length</b>	<b>Living Area</b>	<b>Garage Area</b>	<b>Total Floor Area</b>
9.50m	17.10m	112.68m <sup>2</sup>	26.11m <sup>2</sup>	138.79m <sup>2</sup>

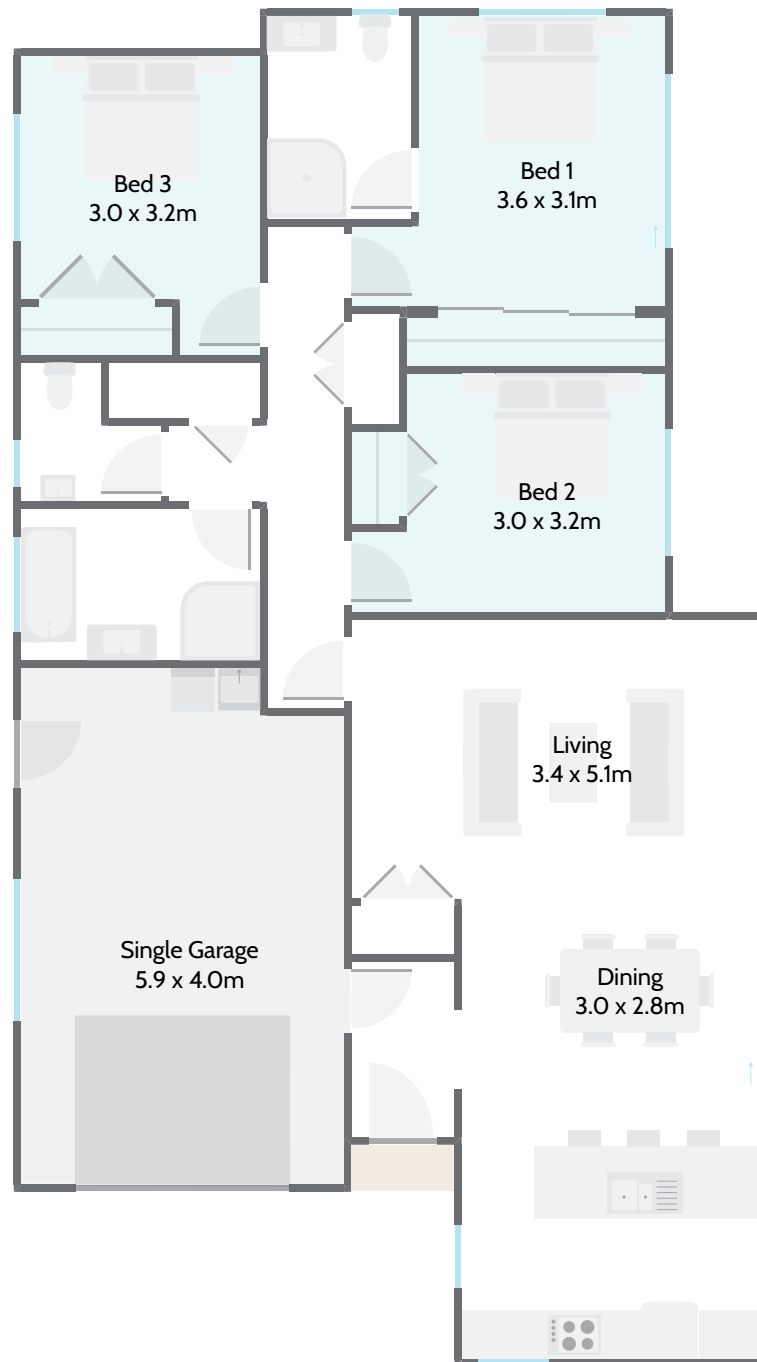

138m<sup>2</sup>



Bedrooms



Bathrooms



Living / Dining



Garage



0800 MILESTONE  
milestonehomes.co.nz