

» LIFESTYLE RANGE Milestone 10



🏠 Style 1: Metal tile hip roof with brick and Linea cladding



🏠 Style 2: Metal tile gable roof with Linea cladding



🏠 Style 3: Longrun gable roof with Linea cladding

The Lifestyle range features 30 stylish home designs created by Milestone Homes to deliver comfortable, quality homes ideal for modern living. Functional and flexible, the cleverly designed Lifestyle range has a proven track record of happy homeowners from professional couples to large families.

Milestone 10

Designer elements and exceptional value come together to create this plan - the ultimate family home.

If your 'must-have' list includes spacious living and dining areas, open plan kitchen, four generous bedrooms, including a master ensuite and plenty of storage, then this home has your name on it!

Highlights:

- Spacious and open plan with plenty of storage
- Additional study nook, ideal to work from home or area for homework
- Access bedrooms directly from the hallway giving the home a perfect flow and functionality
- Option to add an alfresco area available
- The home has the perfect layout for those who love to entertain.

225m²



Bedrooms



Bathrooms



Living / Dining



Garage



📞 0800 MILESTONE
🌐 milestonehomes.co.nz

» LIFESTYLE RANGE

Milestone 10



Home Width	Home Length	Living Area	Garage Area	Total Floor Area
13.23m	23.40m	182.92m ²	42.13m ²	225.05m ²

Measurements are reflective of Style 1

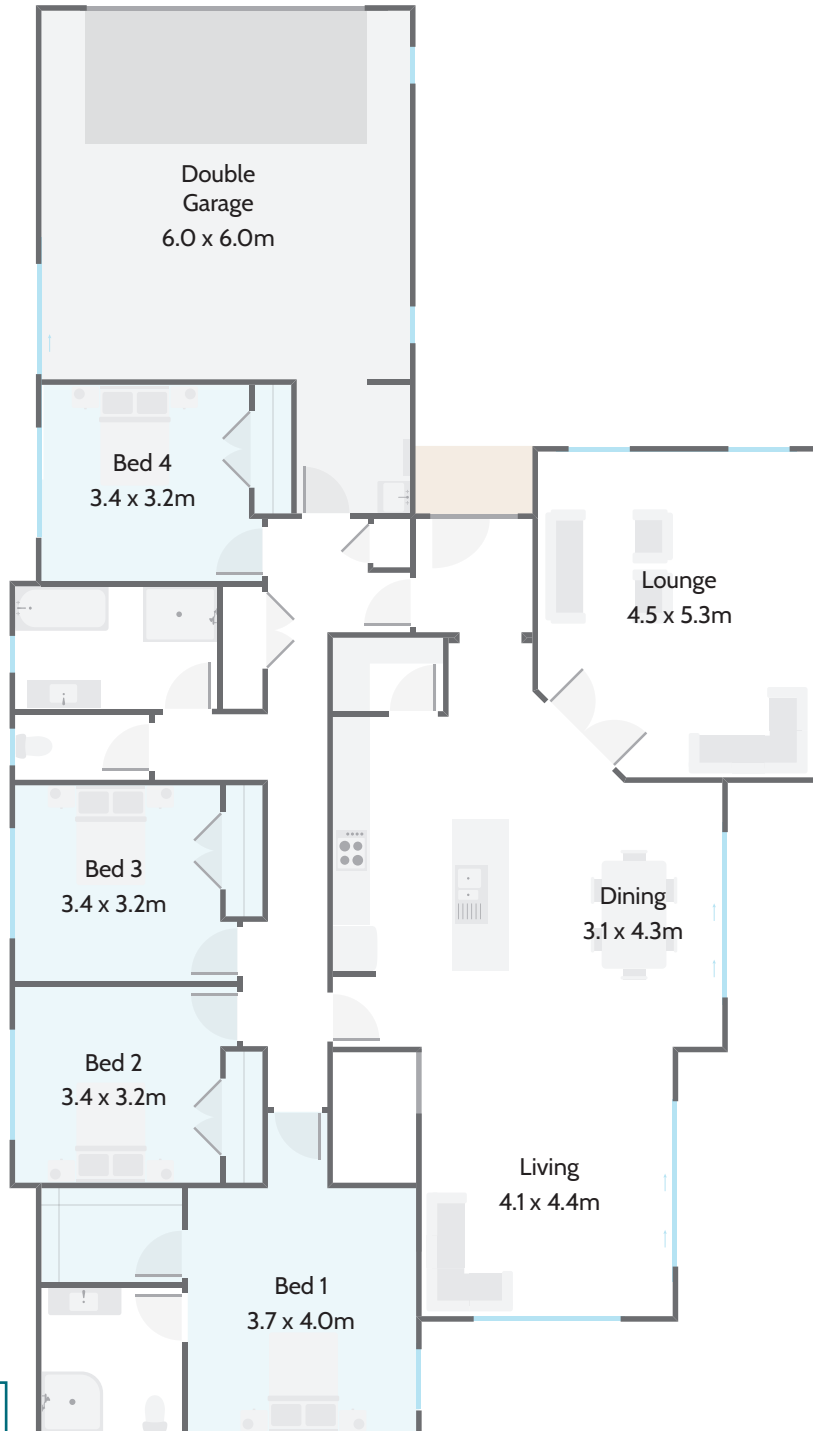

Plan Options:

- Alfresco Area

225m²



Bedrooms



Bathrooms



Living / Dining



Garage



0800 MILESTONE
milestonehomes.co.nz