

» LIFESTYLE RANGE Milestone 19



Style 1: Metal tile hip roof with brick cladding



Style 2: Metal tile gable roof with plaster and Linea cladding



Style 3: Metal tile gable roof with plaster and Linea cladding

The Lifestyle range features 30 stylish home designs created by Milestone Homes to deliver comfortable, quality homes ideal for modern living. Functional and flexible, the cleverly designed Lifestyle range has a proven track record of happy homeowners from professional couples to large families.

Milestone 19

This smart four-bedroom plan is great on smaller sections and has been designed to maximise natural light making great use of available space.

At the heart of this home, the stunning open plan living, dining and kitchen creates an adaptable space that can function as living, entertainment or work area.

With four generous bedrooms, two exquisite bathrooms and a good-sized family area, this is a fantastic option for any family.

Highlights:

- All bedrooms are separate with none backing on to one another
- Bedroom four is accessed easily from the living area adding flexibility in use - it can transform into a music room, study or home office
- Double internal access garage with laundry nook and option to add an alfresco area available.

174m²



Bedrooms



Bathrooms



Living / Dining



Garage



0800 MILESTONE
 milestonehomes.co.nz

» LIFESTYLE RANGE

Milestone 19



Home Width	Home Length	Living Area	Garage Area	Total Floor Area
13.40m	19.11m	134.28m ²	39.22m ²	173.50m ²

Measurements are reflective of Style 1

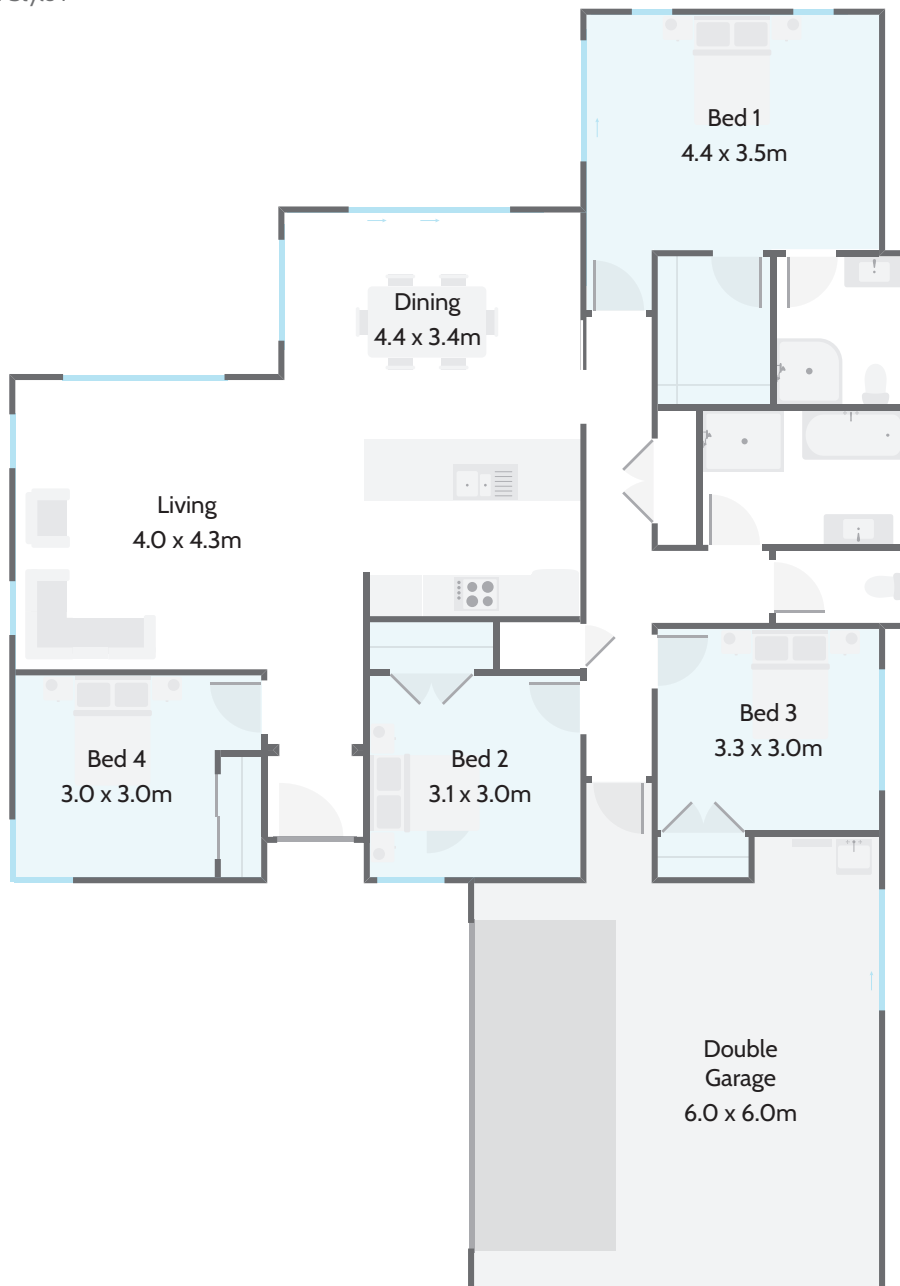

Plan Options:

- Alfresco Area

174m²

Bedrooms

Bathrooms

Living / Dining

Garage



0800 MILESTONE
milestonehomes.co.nz