

» METRO RANGE Mamaku



The Metro range features 10 contemporary home designs created by Milestone Homes to deliver modern living solutions for smaller urban sections. Compact yet packed with new-home comforts, Metro plans are a go-to for professional couples, young families and empty-nesters looking for relaxed, easy-care living.



Mamaku

Featuring an impressive, covered entranceway and gabled roof frontage, the Mamaku home plan stands out from the crowd. The generously proportioned open plan layout lends itself to casual family living and sliding doors connect the space with the outdoors for an easy flow while entertaining.

Comprising three bedrooms, two bathrooms and casual open plan living, the Mamaku floorplan is a compact, contemporary home that delivers modern living and style within a compact footprint.

Highlights:

- Three generous double bedrooms
- Master bedroom with ensuite and walk-in wardrobe
- Work-from-home study nook
- Double internal access garaging
- Garden access from master bedroom and living areas.

141m²

Bedrooms

Bathrooms

Living / Dining

Garage



0800 MILESTONE
milestonehomes.co.nz

» METRO RANGE
Mamaku



Home Width 11.30m	Home Length 16.35m	Living Area 105.95m ²	Garage Area 36.02m ²	Total Floor Area 141.97m ²
-----------------------------	------------------------------	--	---	---

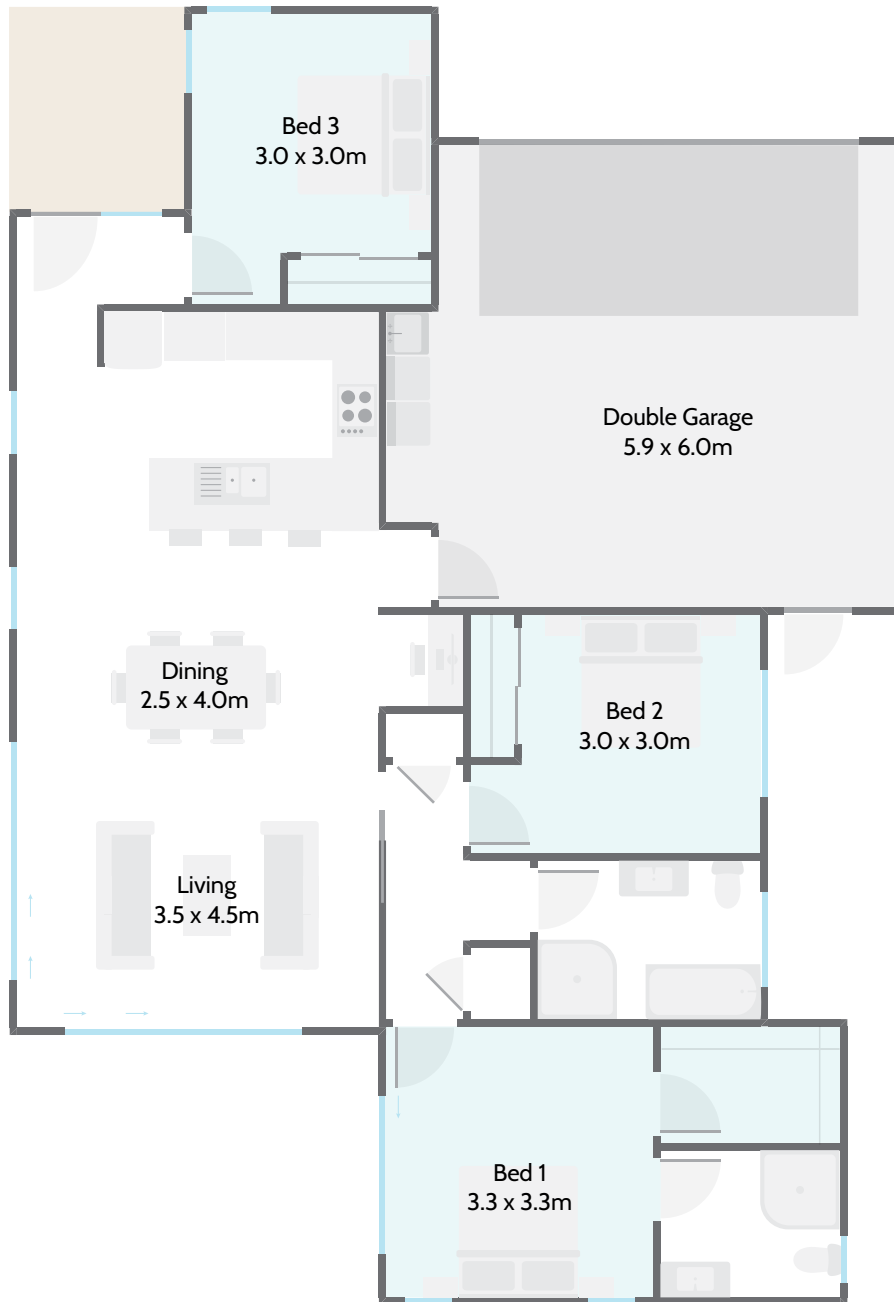

141m²



Bedrooms



Bathrooms



Living / Dining



Garage



0800 MILESTONE
milestonehomes.co.nz