

» LIFESTYLE RANGE  
Kaipara



Style 1: Metal tile hip roof with brick cladding



Style 2: Metal tile gable roof with plaster, Linea and brick cladding



Style 3: Longrun mono roof with plaster and Linea cladding

The Lifestyle range features 30 stylish home designs created by Milestone Homes to deliver comfortable, quality homes ideal for modern living. Functional and flexible, the cleverly designed Lifestyle range has a proven track record of happy homeowners from professional couples to large families.

## Kaipara

This fantastic yet narrow plan is designed to maximise the sun in all of the living areas providing effortless open plan living whilst allowing everyone to have their own space.

Cornerless sliding doors opening to the expansive alfresco area provides a wow factor not often seen in smaller homes with an extra living space outside.

### Highlights:

- Contemporary galley style kitchen
- Large versatile living area to catch the sun
- Double bedrooms with full sized wardrobes
- Master suite with walk-in-robe and ensuite
- Dedicated laundry nook at the rear of the garage.

141m<sup>2</sup>



Bedrooms



Bathrooms



Living / Dining



Garage



0800 MILESTONE  
milestonehomes.co.nz

# » LIFESTYLE RANGE Kaipara



Home Width	Home Length	Living Area	Garage Area	Total Floor Area
9.28m	19.90m	114.16m <sup>2</sup>	26.69m <sup>2</sup>	140.85m <sup>2</sup>

Measurements are reflective of Style 1

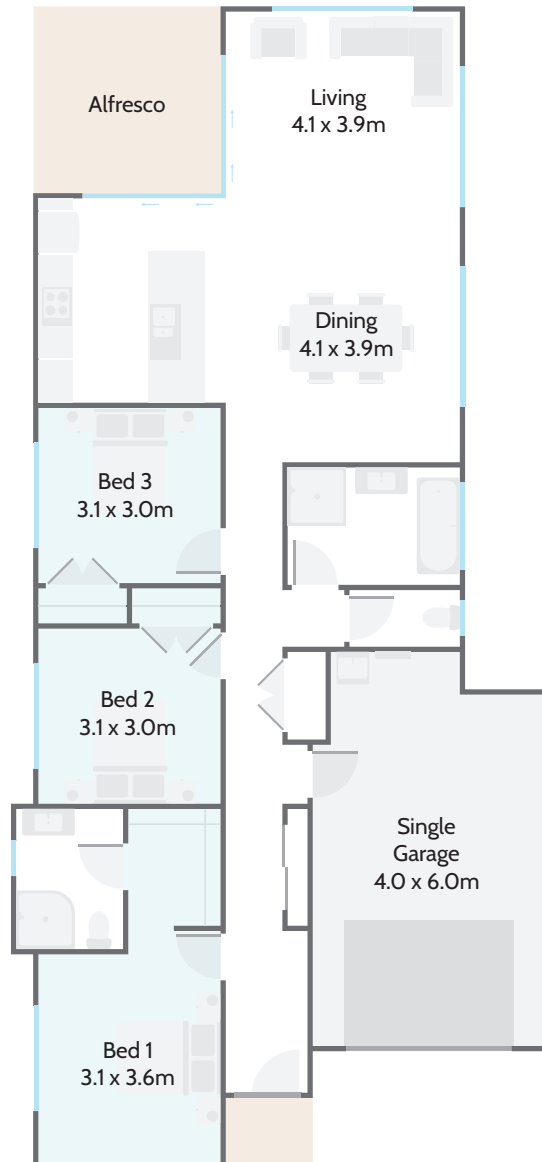

### Plan Options:

- Kitchen/Dining Swap
- Double Garage

141m<sup>2</sup>



Bedrooms



Bathrooms



Living / Dining



Garage



0800 MILESTONE  
milestonehomes.co.nz