

» LIFESTYLE RANGE  
Kaituna



🏠 Style 1: Metal tile hip roof with brick cladding



🏠 Style 2: Longrun hip roof with plaster cladding



🏠 Style 3: Longrun gable roof with plaster and Linea cladding

The Lifestyle range features 30 stylish home designs created by Milestone Homes to deliver comfortable, quality homes ideal for modern living. Functional and flexible, the cleverly designed Lifestyle range has a proven track record of happy homeowners from professional couples to large families.

## Kaituna

This is one of the most popular plans in the range, it is incredibly versatile which suits a huge range of lifestyles and sections.

The home captures the essence of Milestone Homes with its versatility, well thought out and considered design and attractive exterior facades.

### Highlights:

- This proven three-bedroom home has a central kitchen, with ample storage, space and the luxury of a scullery
- Living areas flow easily and allows room for everyone to spread out
- Sliding doors located on two sides of the living areas ensures effortless outside entertaining
- Master suite with walk-in robe and ensuite
- Dedicated laundry nook at the rear of the garage.

186m<sup>2</sup>



Bedrooms



Bathrooms



Living / Dining



Garage



📞 0800 MILESTONE  
🌐 [milestonehomes.co.nz](http://milestonehomes.co.nz)

# » LIFESTYLE RANGE Kaituna



Home Width	Home Length	Living Area	Garage Area	Total Floor Area
13.38m	17.64m	146.17m <sup>2</sup>	39.95m <sup>2</sup>	186.12m <sup>2</sup>

Measurements are reflective of Style 1

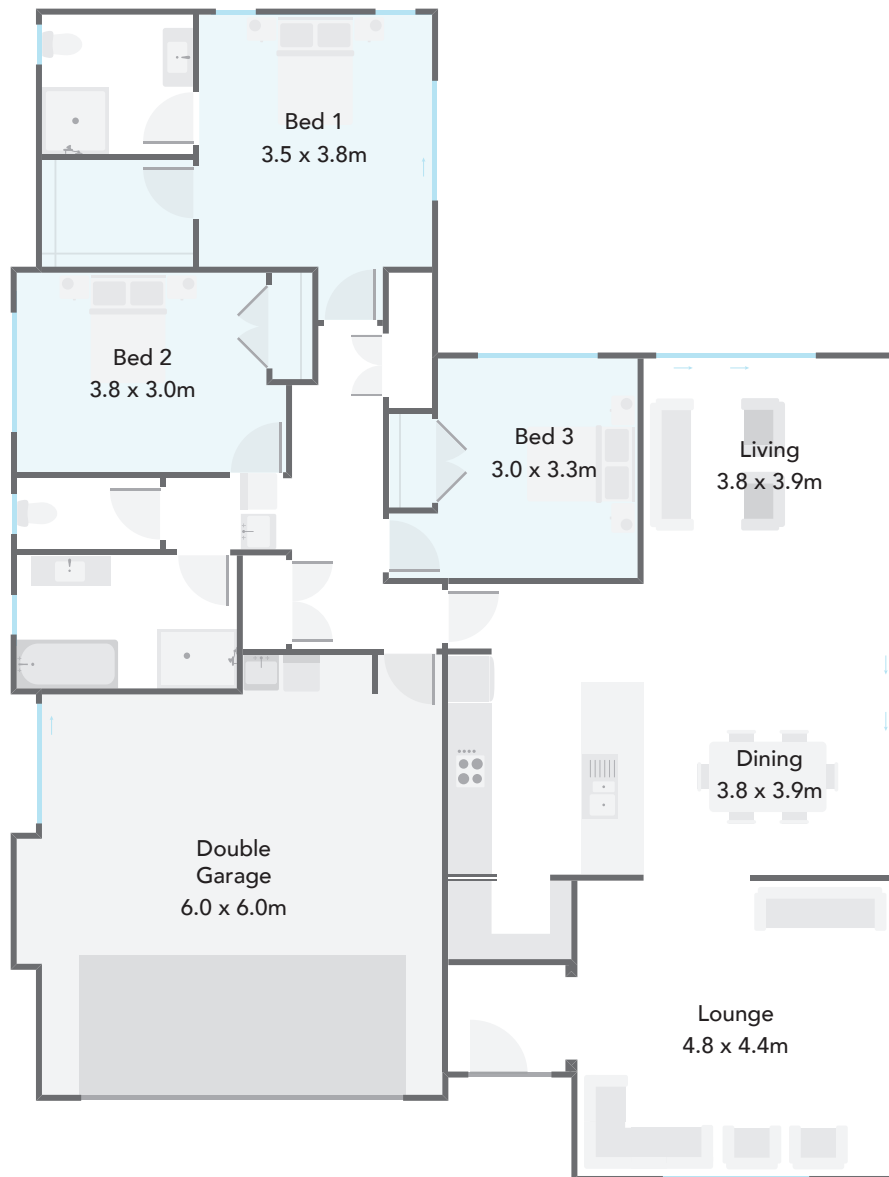

### Plan Options:

- Alfresco Area
- Study
- Laundry Nook

186m<sup>2</sup>



Bedrooms



Bathrooms



Living / Dining



Garage



0800 MILESTONE  
milestonehomes.co.nz