

» LIFESTYLE RANGE Milestone O3



🏠 Style 1: Metal tile hip roof with brick cladding



🏠 Style 2: Metal tile gable roof with plaster and Linea cladding



🏠 Style 3: Metal tile gable roof with plaster and Linea cladding

The Lifestyle range features 30 stylish home designs created by Milestone Homes to deliver comfortable, quality homes ideal for modern living. Functional and flexible, the cleverly designed Lifestyle range has a proven track record of happy homeowners from professional couples to large families.

Milestone O3

This fantastic three-bedroom home has all of the advantages of open plan living whilst providing definition of living spaces.

At under 180m² this home looks and feels more spacious than you imagine.

As with all of our plans, storage and usability are at the forefront so you'll love the full-sized wardrobes and ample storage.

Highlights:

- Master bedroom separate from the other bedrooms providing peace and privacy
- Enjoy a great outlook with numerous windows and doors lining the living areas
- The kitchen design provides ample storage and feels connected to the living areas
- Walk-through laundry.

179m²



Bedrooms



Bathrooms



Living / Dining



Garage



📞 0800 MILESTONE
🌐 milestonehomes.co.nz

» LIFESTYLE RANGE

Milestone O3



Home Width	Home Length	Living Area	Garage Area	Total Floor Area
15.44m	18.37m	137.28m ²	41.27m ²	178.55m ²

Measurements are reflective of Style 1

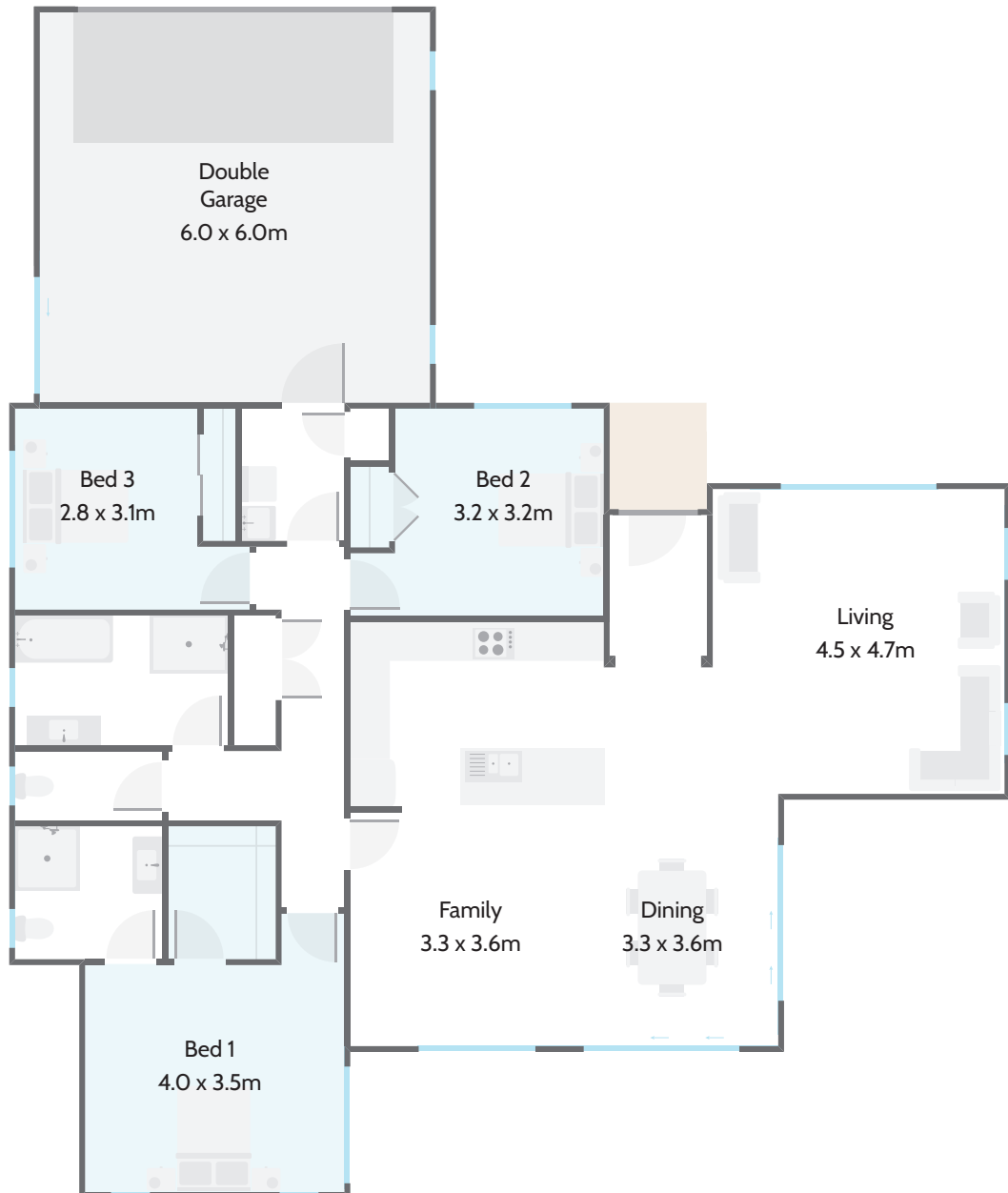

Plan Options:

- 4 Bedroom and Scullery
- 4 Bedroom/Lounge Swap
- Alfresco Area

179m²

Bedrooms

Bathrooms

Living / Dining

Garage



0800 MILESTONE
milestonehomes.co.nz