

» LIFESTYLE RANGE
Milestone O4



🏠 Style 1: Metal tile gable roof with brick and Linea cladding



🏠 Style 2: Metal tile gable roof with plaster and Stria cladding



🏠 Style 3: Longrun gable roof with brick and Linea cladding

The Lifestyle range features 30 stylish home designs created by Milestone Homes to deliver comfortable, quality homes ideal for modern living. Functional and flexible, the cleverly designed Lifestyle range has a proven track record of happy homeowners from professional couples to large families.

Milestone O4

The perfect balance between functionality, space and usability, the staggered living areas makes the most of the open plan design.

Suited to a huge range of sections the living areas along the northern side of the home capture all day sun providing space for the kids to play outside and the perfect spot for BBQ's.

Highlights:

- Master suite is the perfect retreat with an ample walk-in-robe and ensuite
- Bedrooms are generous doubles with plenty of storage
- Centrally located family bathroom and separate toilet is convenient for all
- Large breakfast bar and lounge keeps everyone close to the action while offering space.

188m²



Bedrooms



Bathrooms



Living / Dining



Garage



📞 0800 MILESTONE
🌐 milestonehomes.co.nz

» LIFESTYLE RANGE

Milestone O4



Home Width	Home Length	Living Area	Garage Area	Total Floor Area
12.33m	20.76m	148.76m ²	39.00m ²	187.76m ²

Measurements are reflective of Style 1

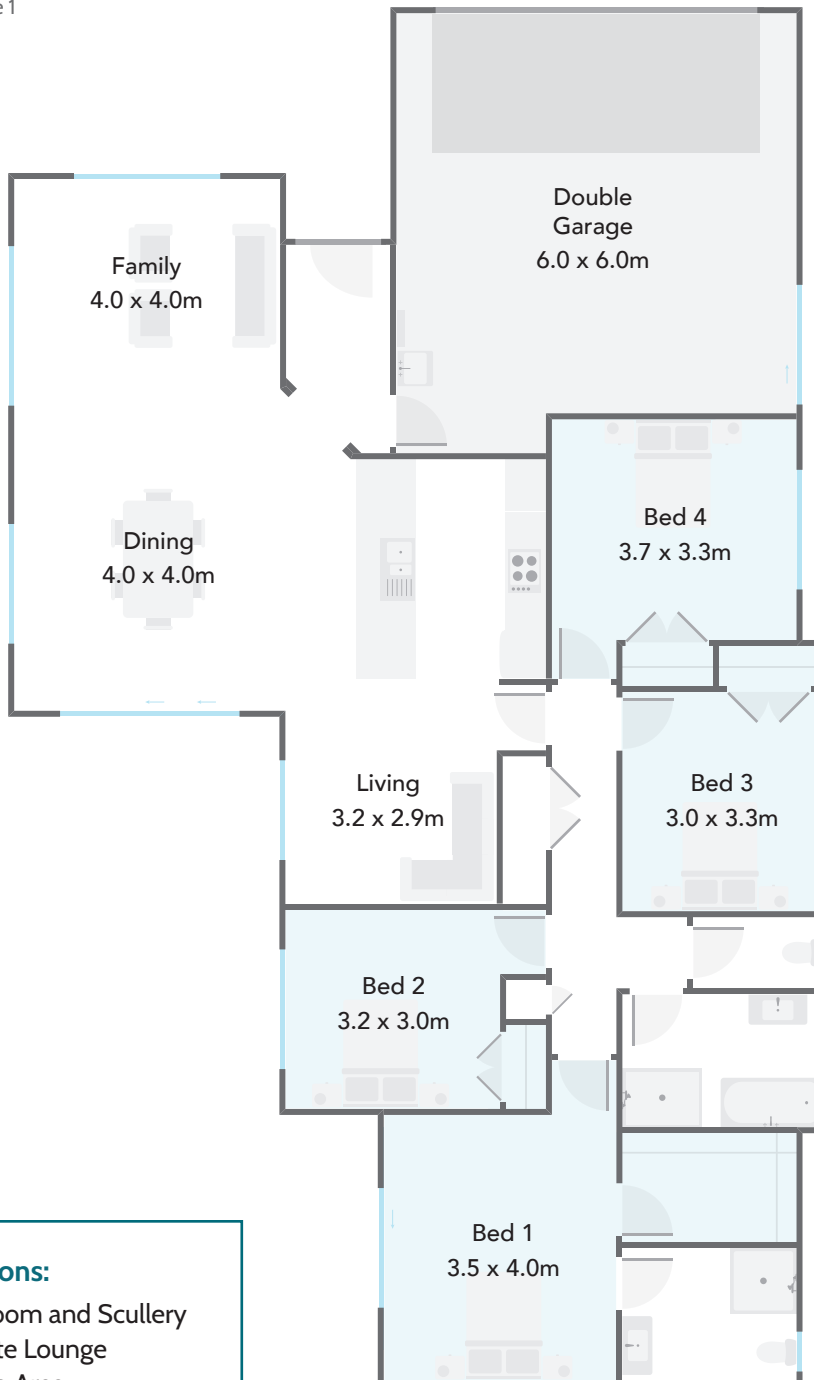

Plan Options:

- 3 Bedroom and Scullery
- Separate Lounge
- Alfresco Area
- Laundry Nook

188m²



Bedrooms



Bathrooms



Living / Dining



Garage



0800 MILESTONE
milestonehomes.co.nz