

» LIFESTYLE RANGE Milestone O8



🏠 Style 1: Metal tile hip roof with brick cladding



🏠 Style 2: Longrun gable roof with Linea cladding



🏠 Style 3: Metal tile gable roof with brick and Linea cladding

The Lifestyle range features 30 stylish home designs created by Milestone Homes to deliver comfortable, quality homes ideal for modern living. Functional and flexible, the cleverly designed Lifestyle range has a proven track record of happy homeowners from professional couples to large families.

Milestone O8

This could be considered one of the smartest plans in the range!

Walk in the entry door and you're greeted with an expansive open plan living area and generous kitchen.

Its shape and size ensures it fits a huge range of sections and the plan itself suits people of all lifestyles.

The stylish façade and cladding options will ensure this plan sits proudly in any location or setting.

Highlights:

- A huge stacking sliding door provides access to the outside living area
- Master bedroom has a walk-in-robe and ensuite
- The modest footprint is efficient on your budget
- Increased living and scullery options available.

151m²



Bedrooms



Bathrooms



Living / Dining



Garage



📞 0800 MILESTONE

🌐 milestonehomes.co.nz

» LIFESTYLE RANGE

Milestone O8



Home Width	Home Length	Living Area	Garage Area	Total Floor Area
11.20m	17.18m	112.45m ²	38.84m ²	151.29m ²

Measurements are reflective of Style 1

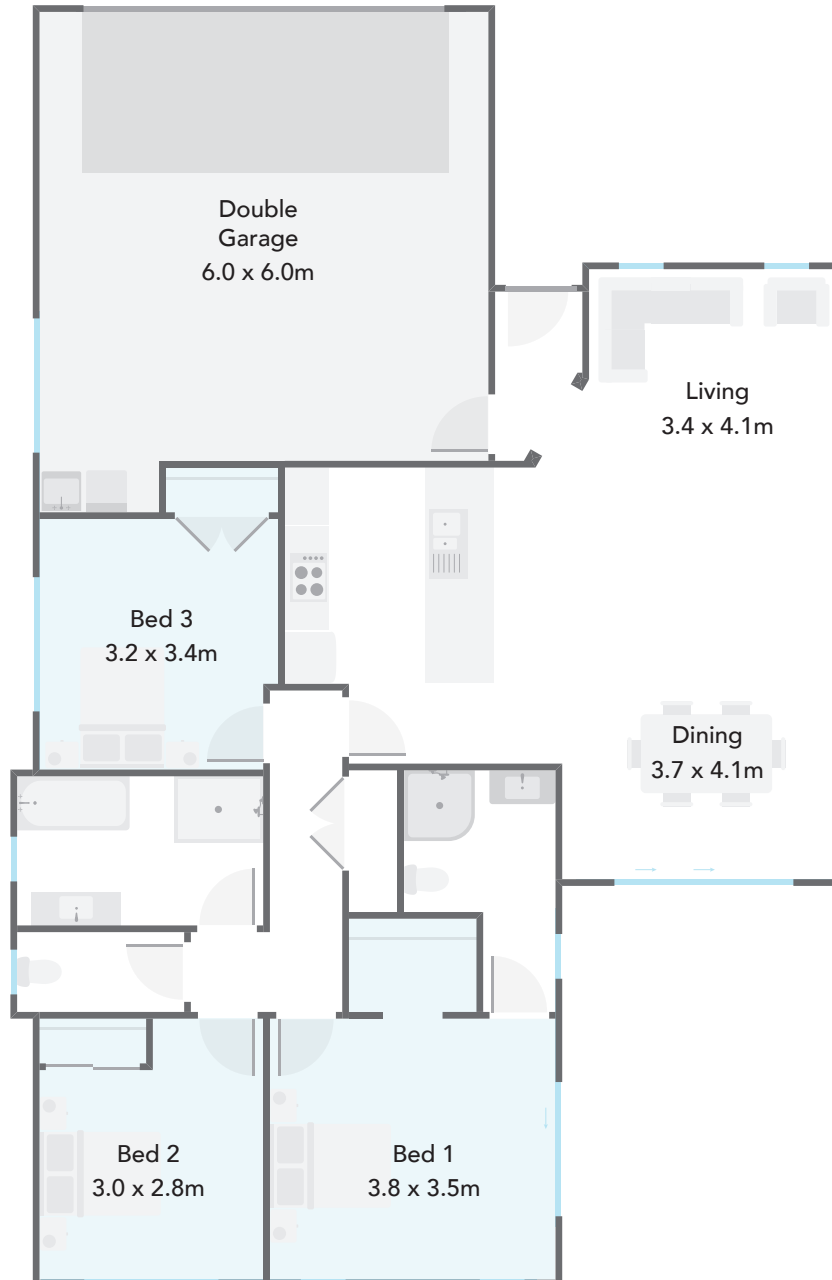

Plan Options:

- Increased Living
- Scullery

151m²



Bedrooms



Bathrooms



Living / Dining



Garage



0800 MILESTONE
milestonehomes.co.nz