



Milestone 03



 **Style 1** Metal tile hip roof with brick cladding



 **Style 2** Metal tile gable roof with plaster and linea cladding



 **Style 3** Metal tile gable roof with plaster and linea cladding



179m²

3

2

2

2

This fantastic 3-bedroom home has all of the advantages of open plan living whilst providing definition of living spaces.

At under 180m² this home looks and feels more spacious than you imagine.

As with all of our plans, storage and usability are at the forefront so you'll love the full-sized wardrobes and ample storage.

Main Features

- Master bedroom separate from the other bedrooms providing peace and privacy.
- Enjoy a great outlook with numerous windows and doors lining the living areas.
- The kitchen design provides ample storage and feels connected to the living areas.
- Walk-through laundry.

Milestone 03

Available Smart Options:

- 4 Bedroom
- 4 Bedroom/Living Swap
- Alfresco Area

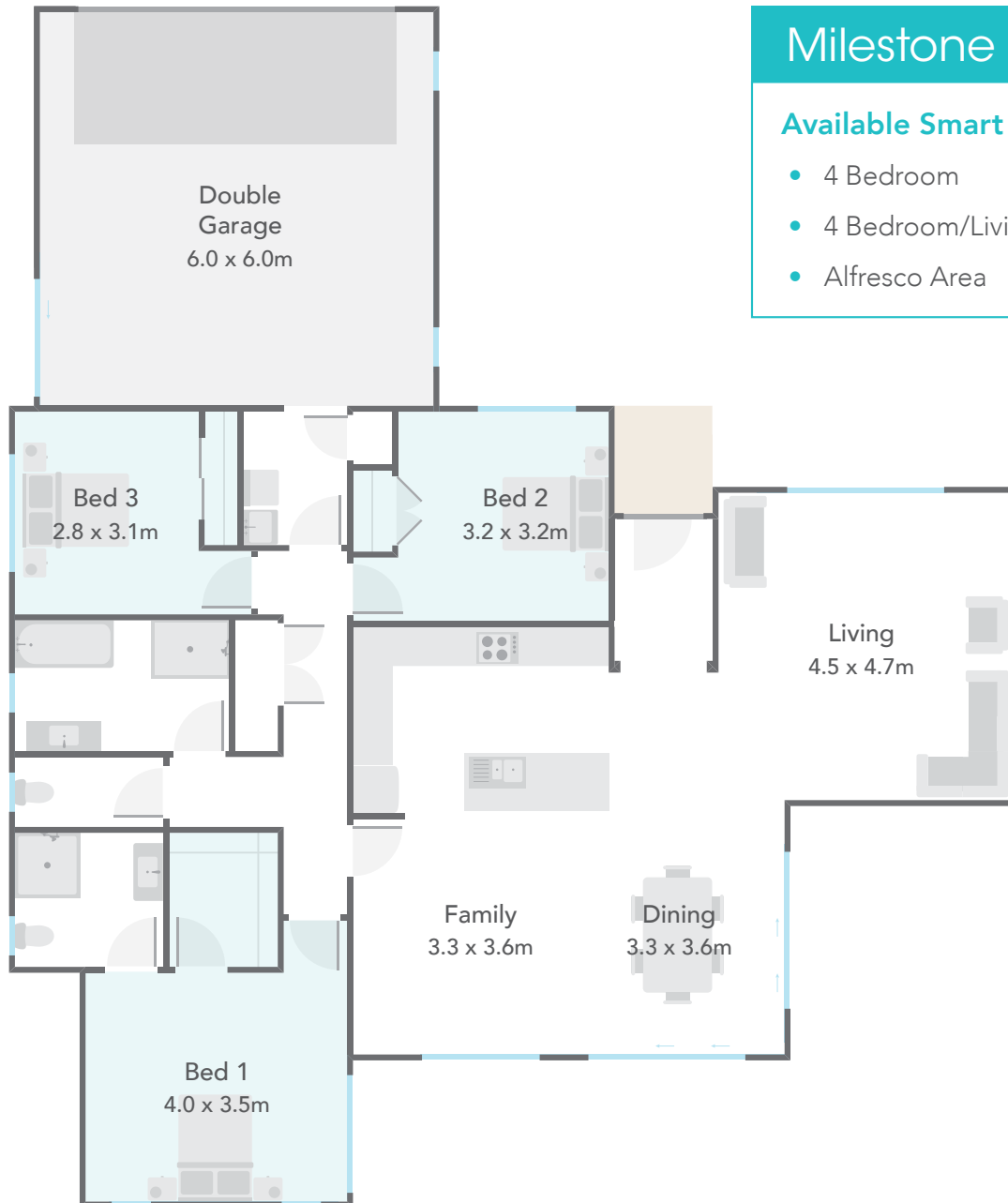

Floor Area	179m ²	Home Width	15.44m	Home Length	18.37m
Living	137.28m ²	Garage	41.27m ²	Total Floor Area	178.55m²

Measurements are reflective of Style 1