



  
milestone

Milestone 10



 **Style 1** Metal tile hip roof with brick and linea cladding



 **Style 2** Metal tile gable roof with linea cladding



 **Style 3** Longrun gable roof with linea cladding







225m<sup>2</sup>      4      2      2      2

Designer elements and exceptional value come together to create this plan - the ultimate family home.

If your 'must have list' includes separate and spacious dining and living areas, open plan kitchen, 4 generous bedrooms including a master ensuite and plenty of storage, then this home has your name on it!

**Main Features**

- Spacious and open plan with plenty of storage.
- Additional study nook, ideal to work from home or area for homework.
- Access bedrooms directly from the hallway giving the home a perfect flow and functionality.
- Option to add an alfresco area available.
- The home has the perfect layout for those who love to entertain.

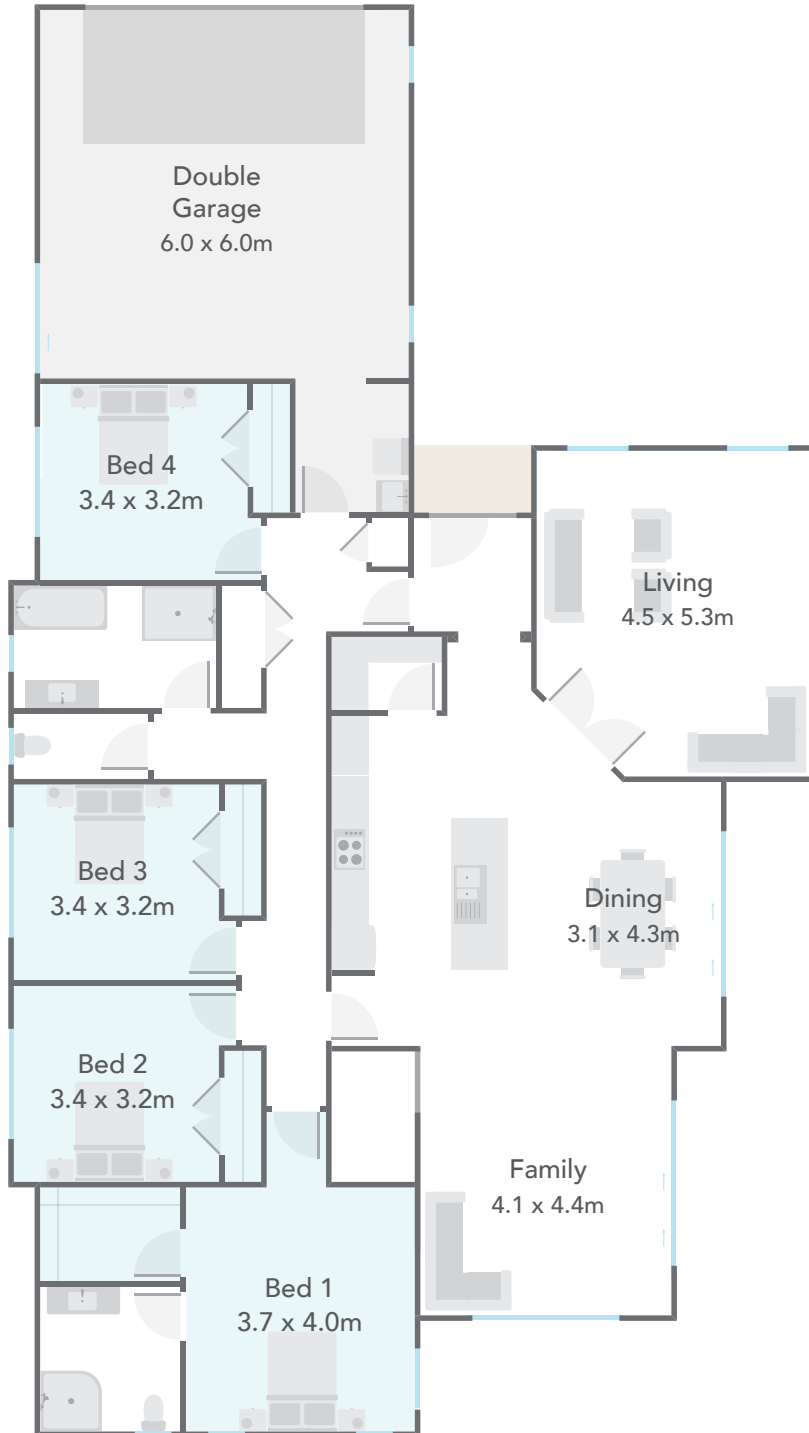

## Milestone 10

### Available Smart Options:

- Alfresco Area

Floor Area	225m <sup>2</sup>	Home Width	13.23m	Home Length	23.40m
Living	182.92m <sup>2</sup>	Garage	42.13m <sup>2</sup>	<b>Total Floor Area</b>	<b>225.05m<sup>2</sup></b>

Measurements are reflective of Style 1