



## Milestone 27



 **Style 1** Metal tile hip roof with brick cladding



 **Style 2** Metal tile gable roof with linea cladding



 **Style 3** Longrun gable roof with plaster and linea cladding



You will be in awe of this incredible plan, originally designed as a show home, this gem suits south entry sections.

The generous entry appeals from the street for a welcoming entrance.

Step into a modern galley kitchen with a lavish scullery, centrally located dining and family area and the generous separate living space.

The 3 ample bedrooms create plenty of space and the master features a large walk-in-robe and ensuite. With 2 well appointed bathrooms, and a walk-in storage cupboard, enhance functionality of this fantastic family home.

### Main Features

- The flexible nook in the living area is perfect for a study, home office or mini bar.
- Internal access double garage with laundry nook.

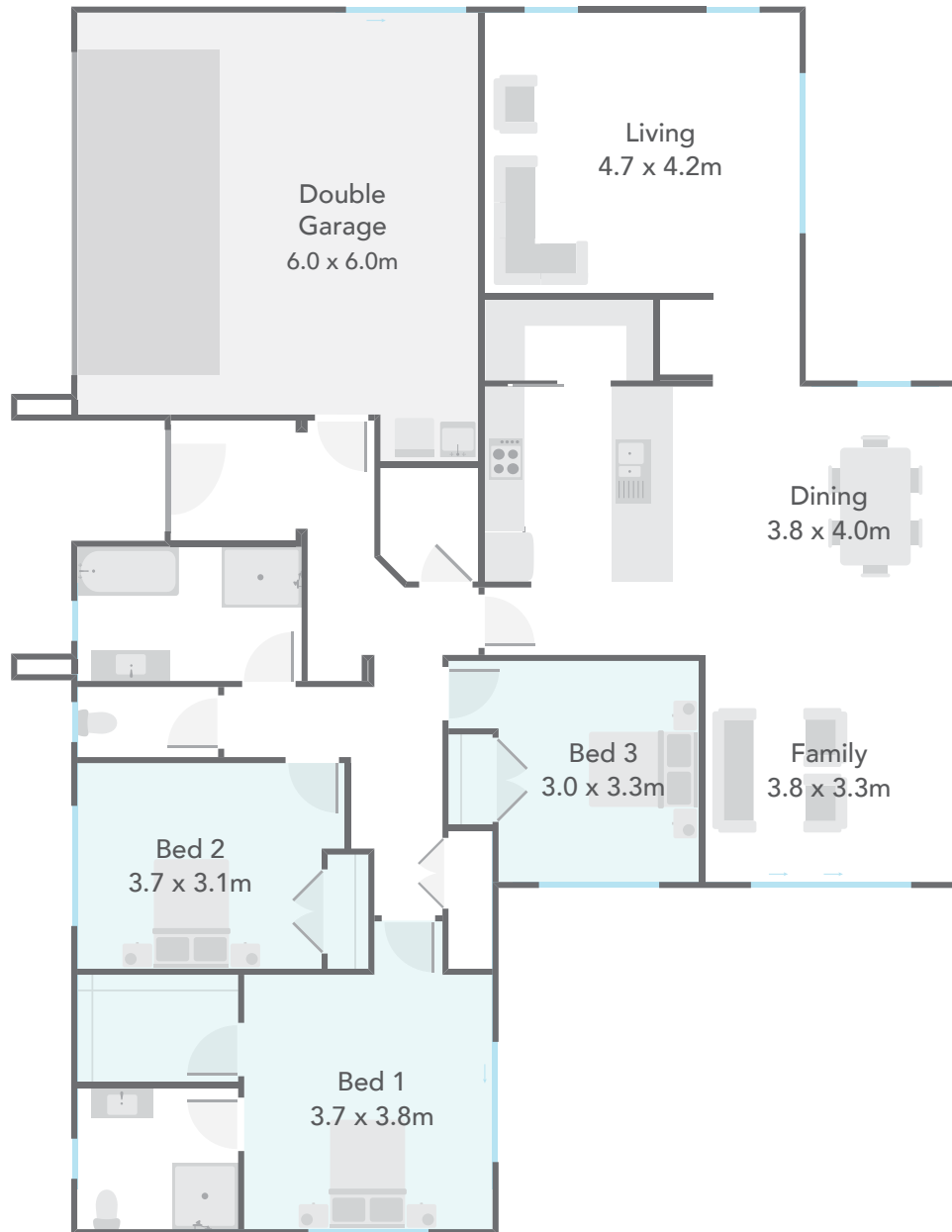

Floor Area	195m <sup>2</sup>	Home Width	14.25m	Home Length	18.40m
Living	155.75m <sup>2</sup>	Garage	38.79m <sup>2</sup>	<b>Total Floor Area</b>	<b>194.54m<sup>2</sup></b>

Measurements are reflective of Style 1