



Milestone 29



 **Style 1** Metal tile hip roof with brick and linea cladding



 **Style 2** Longrun mono roof with plaster and linea cladding



 **Style 3** Longrun mono roof with linea and plaster cladding



188m²

3

1

2

2

This Pavilion style home is ideal for those who desire privacy and space.

The home itself offers open living spaces and includes 3 double bedrooms and 2 bathrooms.

The large galley style kitchen is located at the front and is the hub of the home offering plenty of storage space.

This style includes dedicated wings for both the bedroom and living areas along with a storage cupboard and study nook making for a great functional family home!

Main Features

- Master suite comes complete with a walk-in-robe and ensuite.
- Flexibility to add on an alfresco area for outdoor living.

Milestone 29

Available Smart Options:

- Alfresco Area

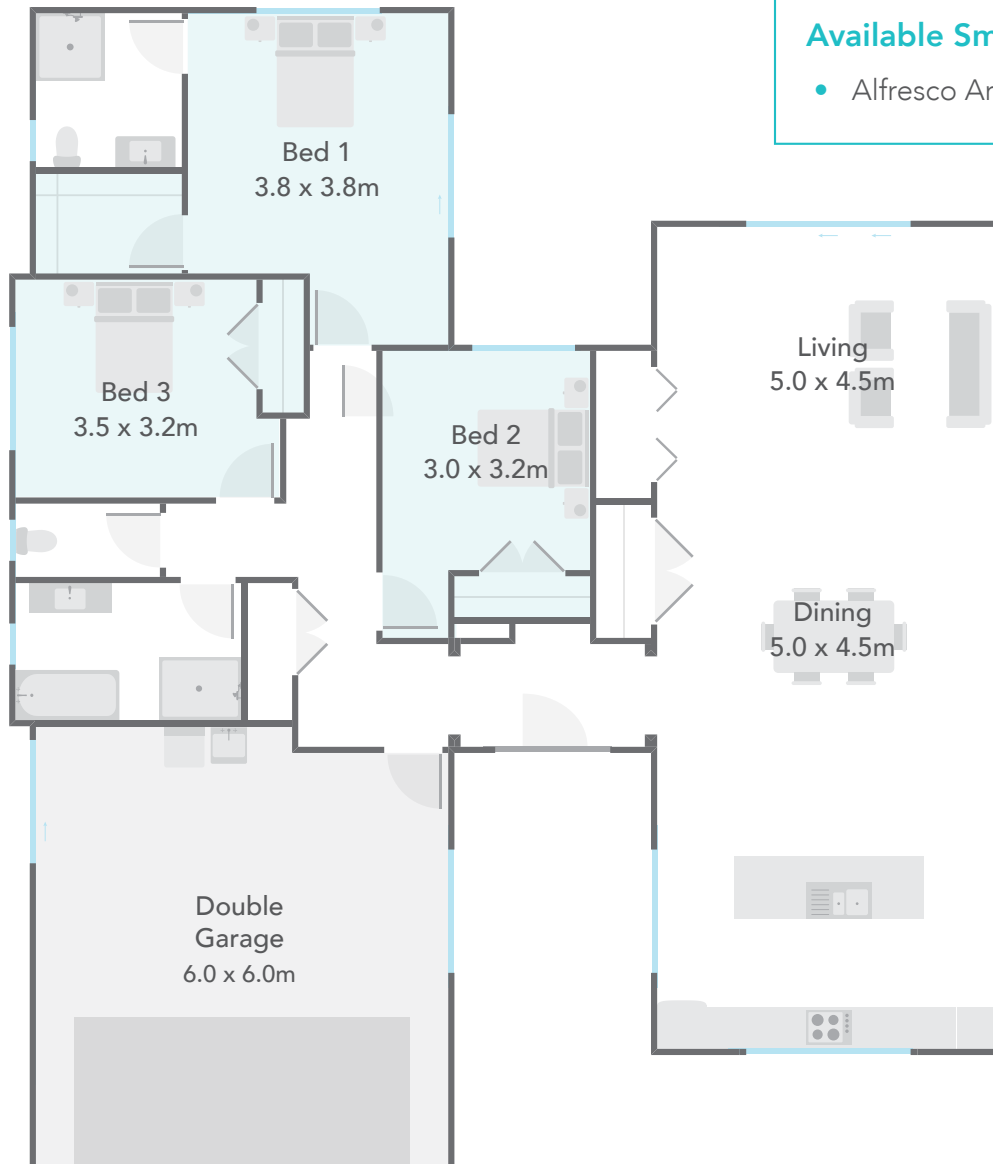

Floor Area	188m ²	Home Width	14.55m	Home Length	17.00m
Living	148.20m ²	Garage	39.38m ²	Total Floor Area	187.58m²

Measurements are reflective of Style 1