

» LIFESTYLE RANGE
Maitai



Style 1: Metal tile hip roof with brick and Linea cladding



Style 2: Longrun mono roof with plaster and Linea cladding



Style 3: Longrun mono roof with Linea and plaster cladding

The Lifestyle range features 30 stylish home designs created by Milestone Homes to deliver comfortable, quality homes ideal for modern living. Functional and flexible, the cleverly designed Lifestyle range has a proven track record of happy homeowners from professional couples to large families.

Maitai

This pavilion style home is ideal for those who desire privacy and space.

The home itself offers open living spaces and includes three double bedrooms and two bathrooms.

The large galley style kitchen is located at the front and is the hub of the home offering plenty of storage space.

This style includes dedicated wings for both the bedroom and living areas along with a storage cupboard and study nook making for a great functional family home!

Highlights:

- Master suite comes complete with a walk-in-robe and ensuite
- Flexibility to add on an alfresco area for outdoor living.

| | | | | |
|-------------------|----------|-----------|-----------------|--------|
| 188m ² | Bedrooms | Bathrooms | Living / Dining | Garage |
| | 3 | 2 | 1 | 2 |

0800 MILESTONE
milestonehomes.co.nz

» LIFESTYLE RANGE

Maitai



| Home Width | Home Length | Living Area | Garage Area | Total Floor Area |
|------------|-------------|----------------------|---------------------|----------------------|
| 14.55m | 17.00m | 148.20m ² | 39.38m ² | 187.58m ² |

Measurements are reflective of Style 1

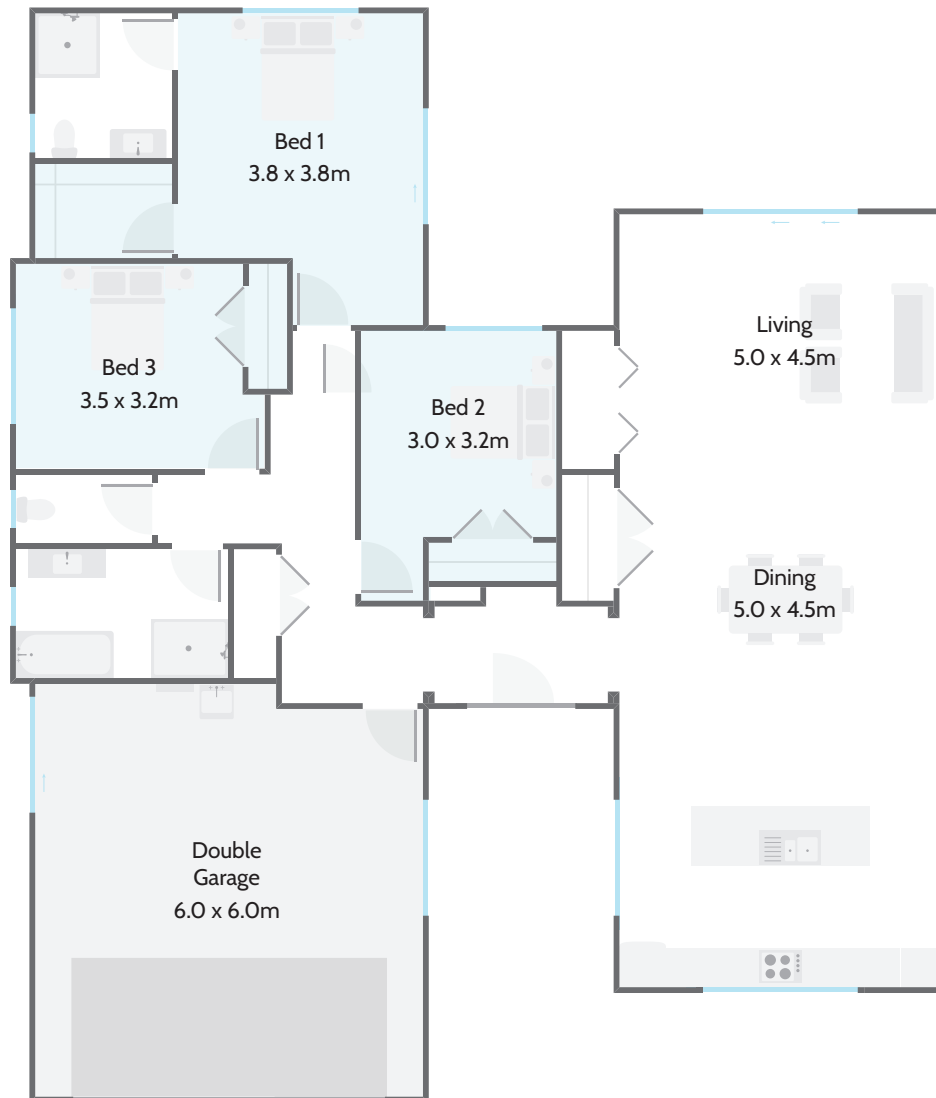

Plan Options:

- Alfresco Area

188m²



Bedrooms



Bathrooms



Living / Dining



Garage



0800 MILESTONE
milestonehomes.co.nz