

» METRO RANGE Aoraki



The Metro range features 10 contemporary home designs created by Milestone Homes to deliver modern living solutions for smaller urban sections. Compact yet packed with new-home comforts, Metro plans are a go-to for professional couples, young families and empty-nesters looking for relaxed, easy-care living.

Aoraki

Classic styling and efficient use of space define the Aoraki home plan from Milestone's Metro Range. At 141m² the Aoraki's family-friendly floorplan ticks all the boxes if your aim is to create a welcoming home on a smaller section.

Comprising three bedrooms, two bathrooms and casual open plan living opening to the outdoors, the Aoraki floorplan delivers on comfort and convenience.

Highlights:

- Three generous double bedrooms
- Master bedroom with ensuite and walk-in wardrobe
- Work-from-home study nook
- Built-in storage throughout
- Garden access from master bedroom and living area.



141m²



Bedrooms



Bathrooms



Living / Dining



Garage



📞 0800 MILESTONE
🌐 milestonehomes.co.nz

» METRO RANGE
Aoraki



Home Width	Home Length	Living Area	Garage Area	Total Floor Area
17.30m	10.95m	104.06m ²	37.08m ²	141.14m ²

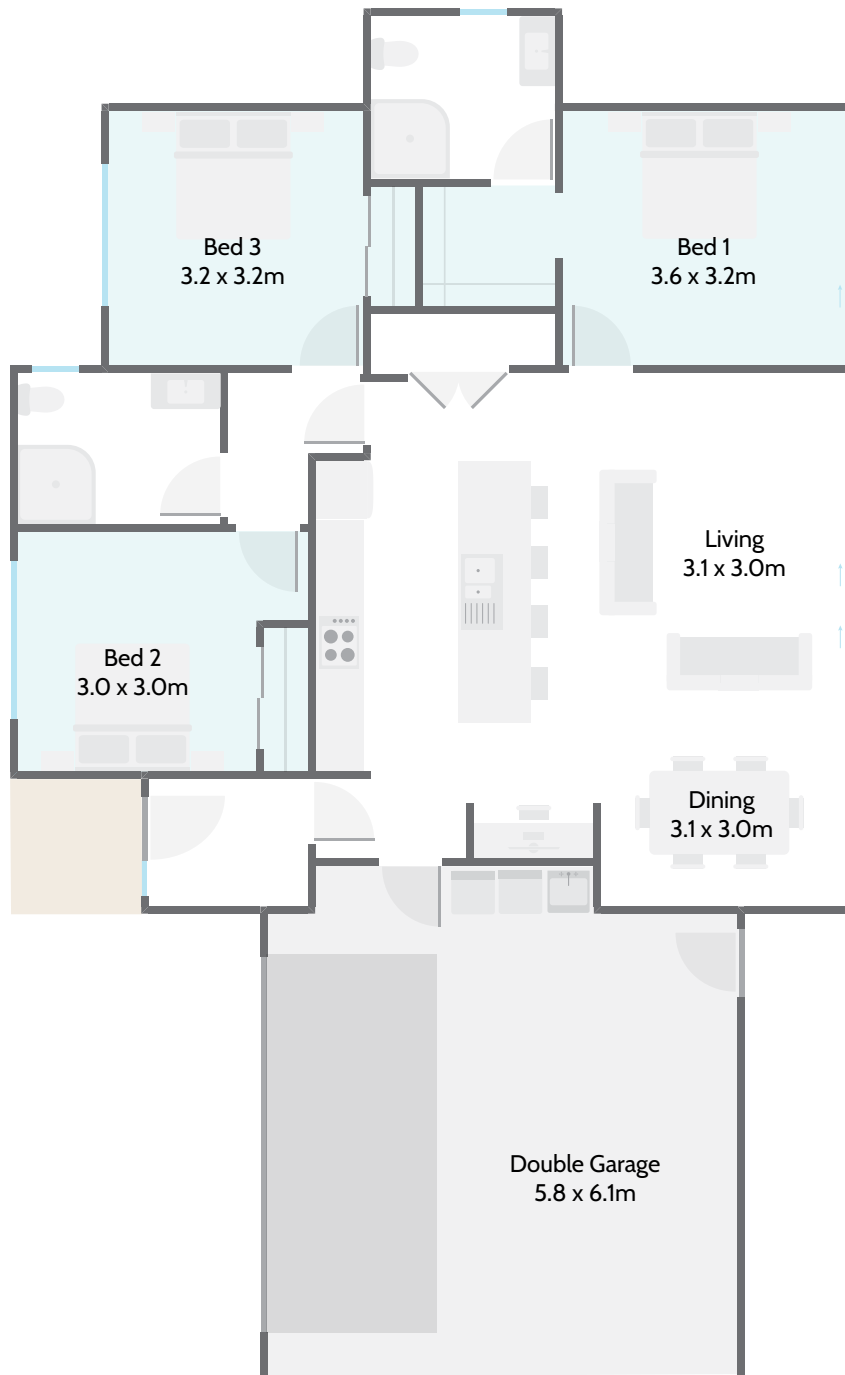

141m²

Bedrooms

Bathrooms

Living / Dining

Garage



0800 MILESTONE
milestonehomes.co.nz