

## » METRO RANGE

### Hūnua



The Metro range features 10 contemporary home designs created by Milestone Homes to deliver modern living solutions for smaller urban sections. Compact yet packed with new-home comforts, Metro plans are a go-to for professional couples, young families and empty-nesters looking for relaxed, easy-care living.



## Hūnua

The Hūnua home plan combines the essentials of modern living with a cleverly designed layout that's perfect for a smaller section. If you're looking for a first home, a base for a young family, or you're downsizing to simplify, you'll find the Hūnua a great fit.

Comprising three bedrooms, two bathrooms and spacious open plan living spaces, the compact 116m<sup>2</sup> footprint means your new home aspirations are achievable without compromising on quality, comfort, or style.

### Highlights:

- Sleek compact design
- Master bedroom with ensuite and walk-in wardrobe
- Sunny open plan living with garden views
- Generous storage
- Secure internal access garage.

116m<sup>2</sup>

Bedrooms

Bathrooms

Living / Dining

Garage



📞 0800 MILESTONE  
🌐 [milestonehomes.co.nz](https://milestonehomes.co.nz)

# » METRO RANGE

## Hūnua



<b>Home Width</b> 7.80m	<b>Home Length</b> 18.50m	<b>Living Area</b> 95.30m <sup>2</sup>	<b>Garage Area</b> 21.42m <sup>2</sup>	<b>Total Floor Area</b> 116.72m <sup>2</sup>
----------------------------	------------------------------	---	---	---

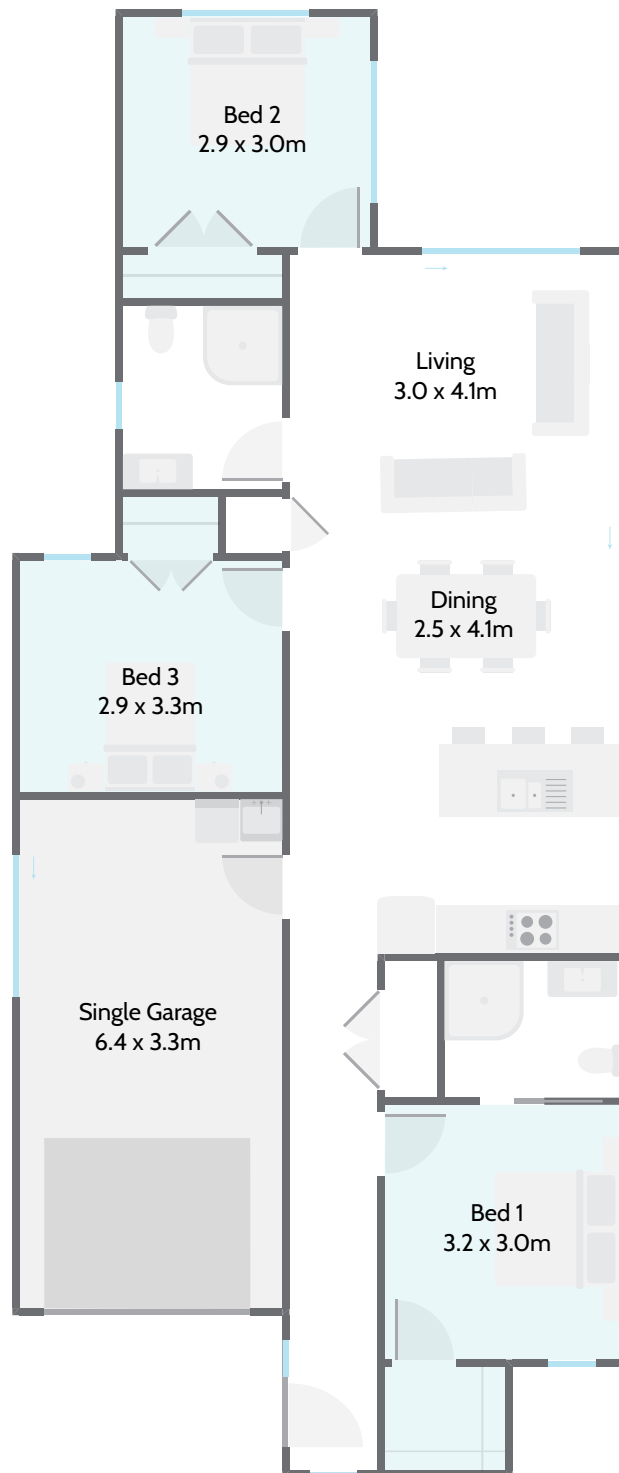

116m<sup>2</sup>



Bedrooms



Bathrooms



Living / Dining



Garage



0800 MILESTONE  
milestonehomes.co.nz