

» METRO RANGE

Hunua



The Metro range features 10 contemporary home designs created by Milestone Homes to deliver modern living solutions for smaller urban sections. Compact yet packed with new-home comforts, Metro plans are a go-to for professional couples, young families and empty-nesters looking for relaxed, easy-care living.



Hunua

The Hunua home plan combines the essentials of modern living with a cleverly designed layout that's perfect for a smaller section. If you're looking for a first home, a base for a young family, or you're downsizing to simplify, you'll find the Hunua a great fit.

Comprising three bedrooms, two bathrooms and spacious open plan living spaces, the compact 116m² footprint means your new home aspirations are achievable without compromising on quality, comfort, or style.

Highlights:

- Sleek compact design
- Master bedroom with ensuite and walk-in wardrobe
- Sunny open plan living with garden views
- Generous storage
- Secure internal access garage.

116m²

Bedrooms

Bathrooms

Living / Dining

Garage



📞 0800 MILESTONE
🌐 milestonehomes.co.nz

» METRO RANGE
Hunua



Home Width 7.80m	Home Length 18.50m	Living Area 95.30m ²	Garage Area 21.42m ²	Total Floor Area 116.72m ²
----------------------------	------------------------------	---	---	---

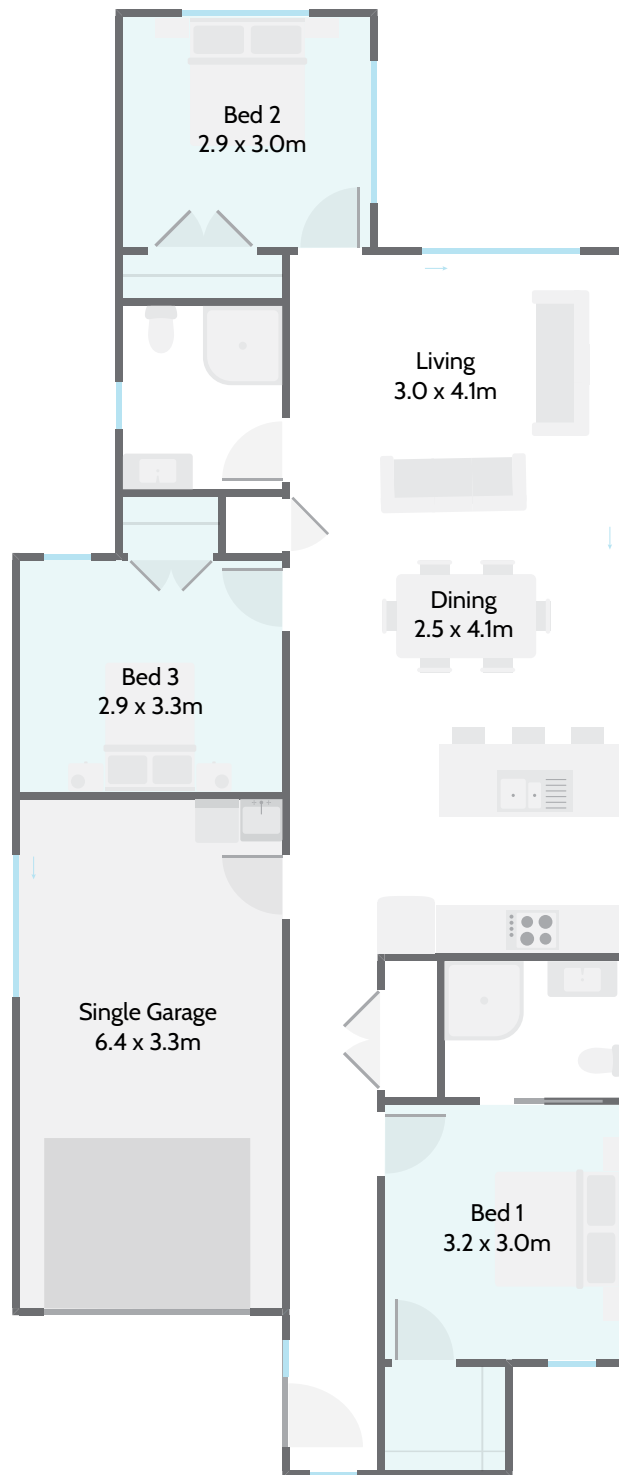

116m²



Bedrooms



Bathrooms



Living / Dining



Garage



0800 MILESTONE
milestonehomes.co.nz