

» METRO RANGE Tākitimu



The Metro range features 10 contemporary home designs created by Milestone Homes to deliver modern living solutions for smaller urban sections. Compact yet packed with new-home comforts, Metro plans are a go-to for professional couples, young families and empty-nesters looking for relaxed, easy-care living.

Tākitimu

Featuring a contemporary pitched roof and stylish exterior, the Tākitimu home plan delivers on efficient use of space without compromise. With its cleverly designed compact layout and ample storage, the Tākitimu is a great fit for young families, first home buyers or those looking to downsize and simplify.

Comprising three bedrooms, two bathrooms and open plan living connecting with the outdoors, the Tākitimu floorplan creates a stylish home that delivers on the essentials of modern living.

Highlights:

- Master bedroom with ensuite and walk-in wardrobe
- Family bathroom with separate toilet
- Generous storage
- Double internal access garaging
- Garden access from master bedroom and living areas.



143m²

Bedrooms

Bathrooms

Living / Dining

Garage



📞 0800 MILESTONE
🌐 milestonehomes.co.nz

» METRO RANGE
Tākitimu



Home Width 10.00m	Home Length 18.50m	Living Area 108.27m ²	Garage Area 35.19m ²	Total Floor Area 143.46m ²
-----------------------------	------------------------------	--	---	---

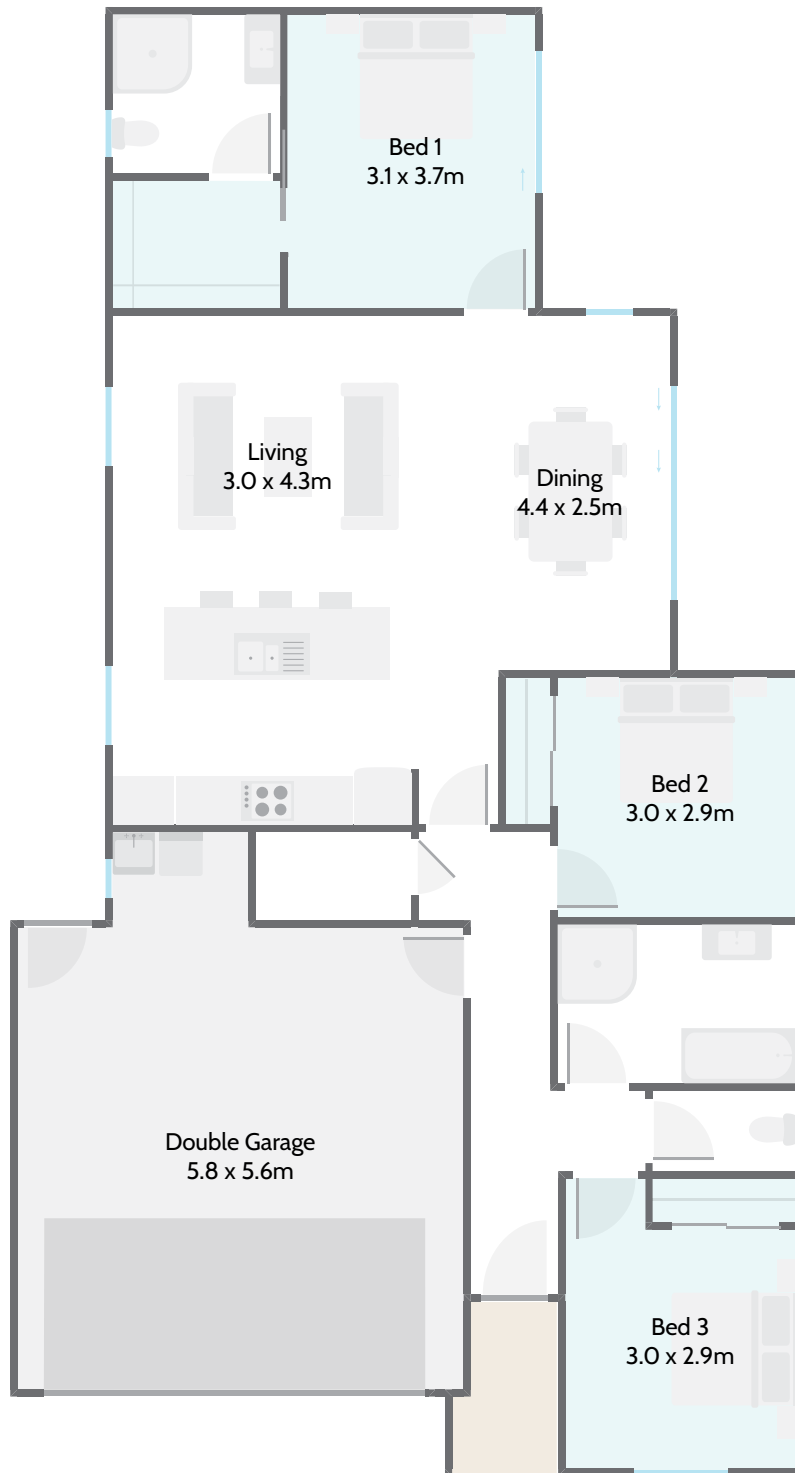

143m²



Bedrooms



Bathrooms



Living / Dining



Garage



0800 MILESTONE
milestonehomes.co.nz