

» METRO RANGE Tararua



The Metro range features 10 contemporary home designs created by Milestone Homes to deliver modern living solutions for smaller urban sections. Compact yet packed with new-home comforts, Metro plans are a go-to for professional couples, young families and empty-nesters looking for relaxed, easy-care living.

Tararua

Sun and space define the contemporary Tararua home plan from the Metro Range. Designed for an easy flow to outdoor living, the Tararua floorplan delivers modern comfort and relaxed family living.

Comprising three bedrooms, two bathrooms and casual open plan living spaces, the Tararua home plan has a light and spacious feel contained within a compact 139m² footprint.

Highlights:

- Master bedroom with ensuite and walk-in wardrobe
- Flexible open plan living
- Space-saver laundry conveniently placed in garage
- Double internal access garaging
- Garden access from master bedroom and living areas.



139m²



Bedrooms



Bathrooms



Living / Dining



Garage



📞 0800 MILESTONE
🌐 milestonehomes.co.nz

» METRO RANGE
Tararua



Home Width	Home Length	Living Area	Garage Area	Total Floor Area
10.60m	20.10m	103.85m ²	36.12m ²	139.97m ²

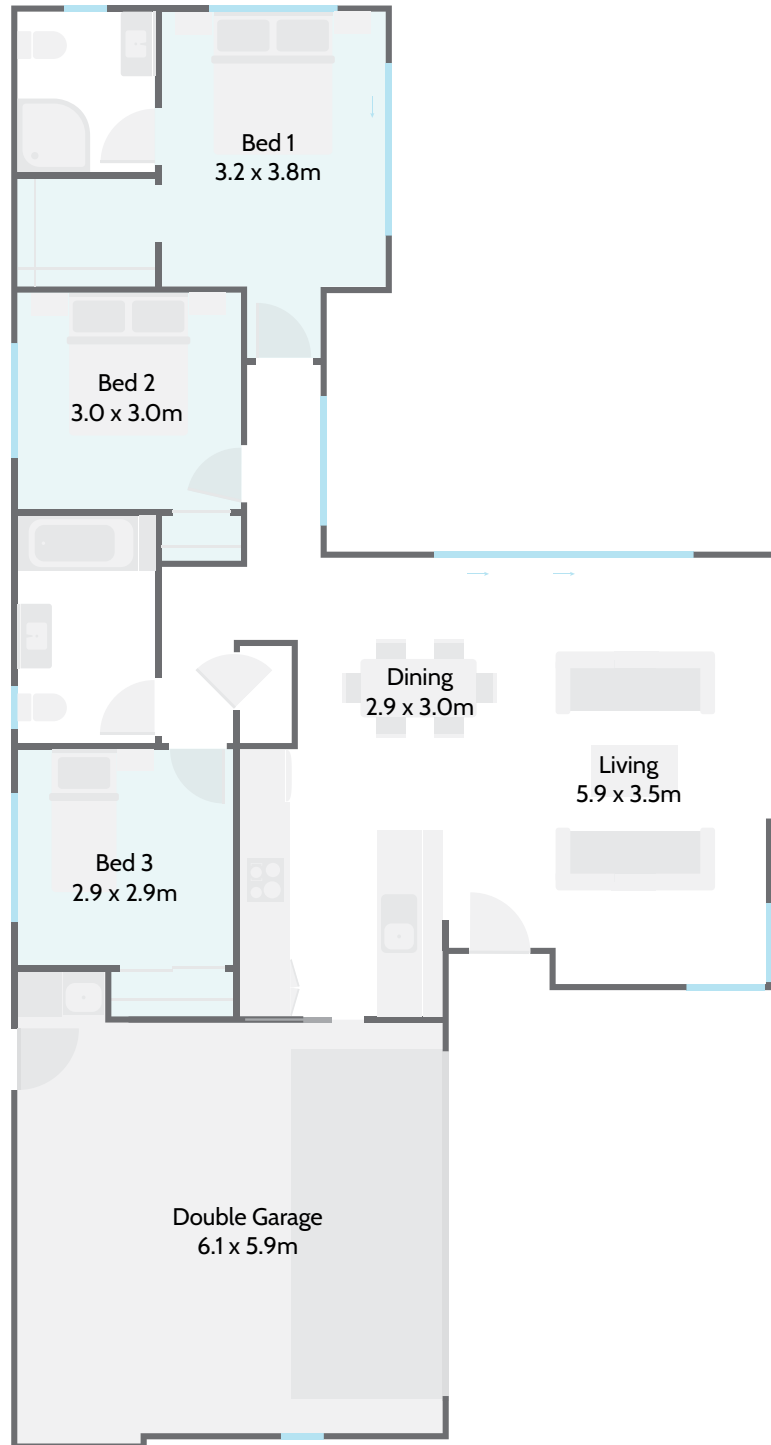

139m²



Bedrooms



Bathrooms



Living / Dining



Garage



0800 MILESTONE
milestonehomes.co.nz