

» COUNTRY RANGE

Tarawera



The Country range features six spacious home designs created by Milestone Homes to offer comfortable, modern living with proportions perfectly suited to a rural setting, lifestyle block or larger section size. Generous and designed to connect with the outdoors, the Country range are a top pick for large families or lifestylers seeking space and a touch of luxury.



Tarawera

Family-friendly and brimming with the essentials of modern life, the contemporary Tarawera floorplan delivers on comfort, convenience and good looks. With living areas opening to multiple sheltered outdoor spaces, the Tarawera creates the perfect environment to host friends and family, and relax and enjoy the lifestyle you've dreamed of.

Comprising four generous bedrooms, two bathrooms and spacious interconnected living areas plus an office, the Tarawera promises space and flexibility.

Highlights:

- Four generous double bedrooms
- Master bedroom with ensuite and walk-in wardrobe
- Separate lounge
- Work-from-home office
- Sheltered alfresco area
- Fully insulated double internal access garage.

292m²



Bedrooms



Bathrooms



Living / Dining



Garage



0800 MILESTONE
milestonehomes.co.nz

» COUNTRY RANGE

Tarawera



Home Width	Home Length	Living Area	Garage Area	Total Floor Area
19.08m	23.86m	244.94m ²	46.38m ²	292.29m ²

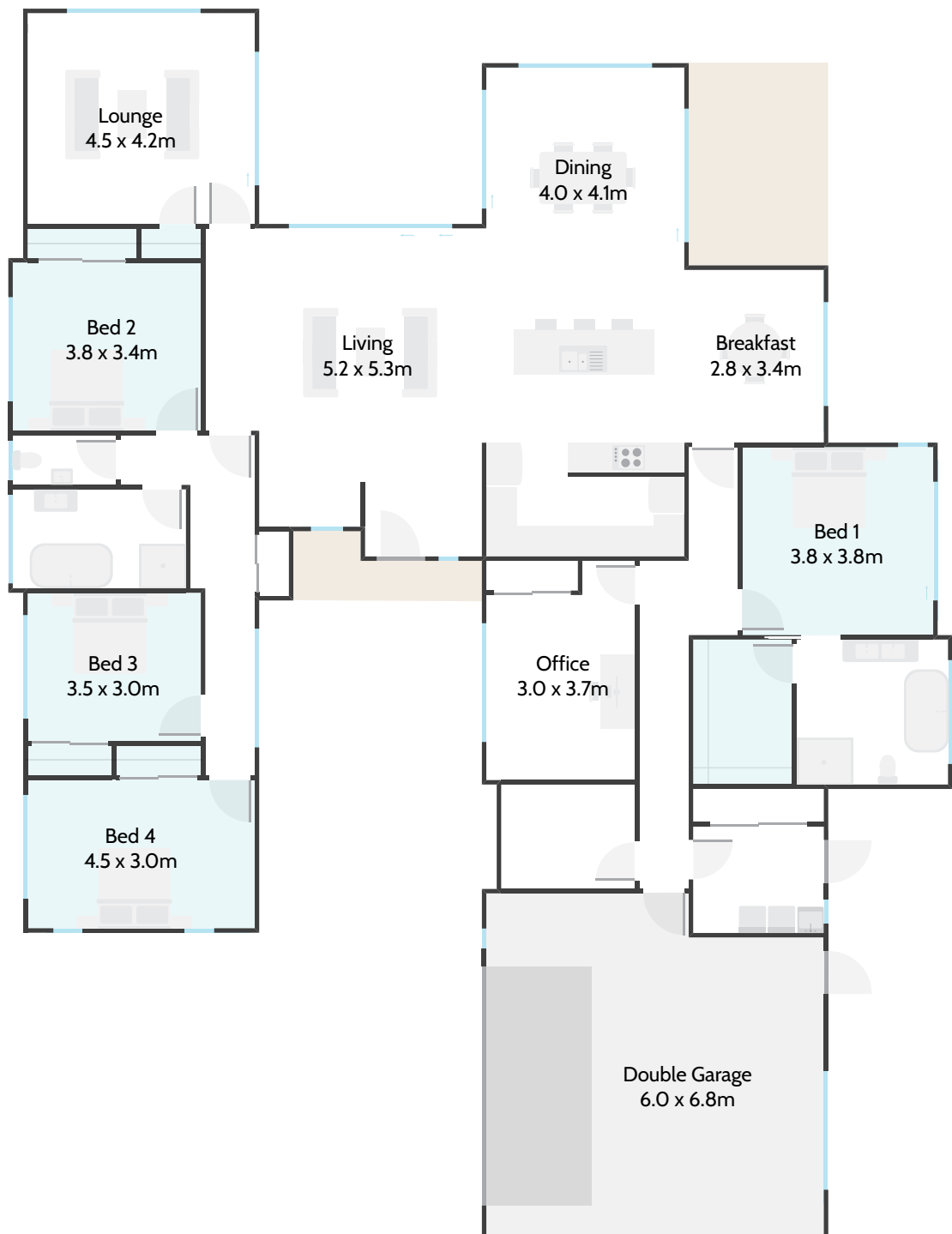

292m²



Bedrooms



Bathrooms



Living / Dining



Garage



0800 MILESTONE
milestonehomes.co.nz