

» LIFESTYLE RANGE  
Tasman



Style 1: Longrun hip roof with plaster cladding



Style 2: Longrun mono roof with plaster and Linea cladding



Style 3: Metal tile gable roof with brick and Linea cladding

The Lifestyle range features 30 stylish home designs created by Milestone Homes to deliver comfortable, quality homes ideal for modern living. Functional and flexible, the cleverly designed Lifestyle range has a proven track record of happy homeowners from professional couples to large families.

## Tasman

This fabulous design is thoughtfully planned, efficiently using space to suit the growing modern family.

It is a wide yet shallow plan, offering three ample double bedrooms.

The light-filled open plan kitchen, dining and living areas, are all located at one end of the home, offering excellent functional space and all-day sun.

Additionally, there is a great sized family bathroom, separate toilet and a slightly oversized double garage to accommodate a laundry nook.

Stylish design embodies this smart home.

### Highlights:

- Plentiful master bedroom complemented by a very generous walk-in-robe and ensuite
- Extended living option available.

160m<sup>2</sup>



Bedrooms



Bathrooms



Living / Dining



Garage



0800 MILESTONE  
milestonehomes.co.nz

# » LIFESTYLE RANGE Tasman



Home Width	Home Length	Living Area	Garage Area	Total Floor Area
8.90m	20.95m	120.13m <sup>2</sup>	40.11m <sup>2</sup>	160.24m <sup>2</sup>

Measurements are reflective of Style 1

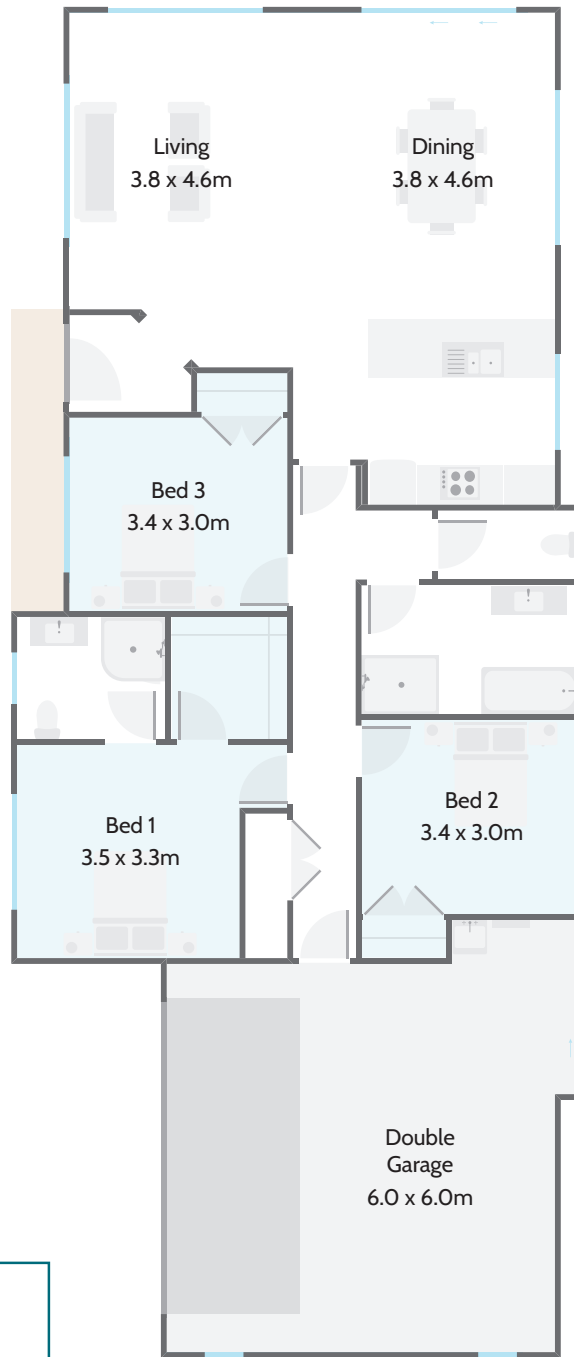

- Plan Options:**
- Increased Living

160m<sup>2</sup>



Bedrooms



Bathrooms



Living / Dining



Garage



0800 MILESTONE  
milestonehomes.co.nz